

Trax EH

Electrified horizontal slot display system

3rd edition

CUBIC *The longest shelf life.*

Discover CUBIC...

Go on, get creative...

CUBIC *The longest shelf life.*

The electrified profile of tomorrow

Trax EH is a low voltage electrified profile designed for powering electronic devices of today and tomorrow. With multiple shelving and merchandising options, Trax EH is the horizontal display system that ticks all the boxes.



Durable for today, renewable for tomorrow

We often say 'a product with longevity is the modern way' but that's not where we stop. Trax EH profiles, shelves and accessories are all made from highly recyclable materials. So when the time comes to bid farewell, rest assured that they don't have to become a burden on our world.

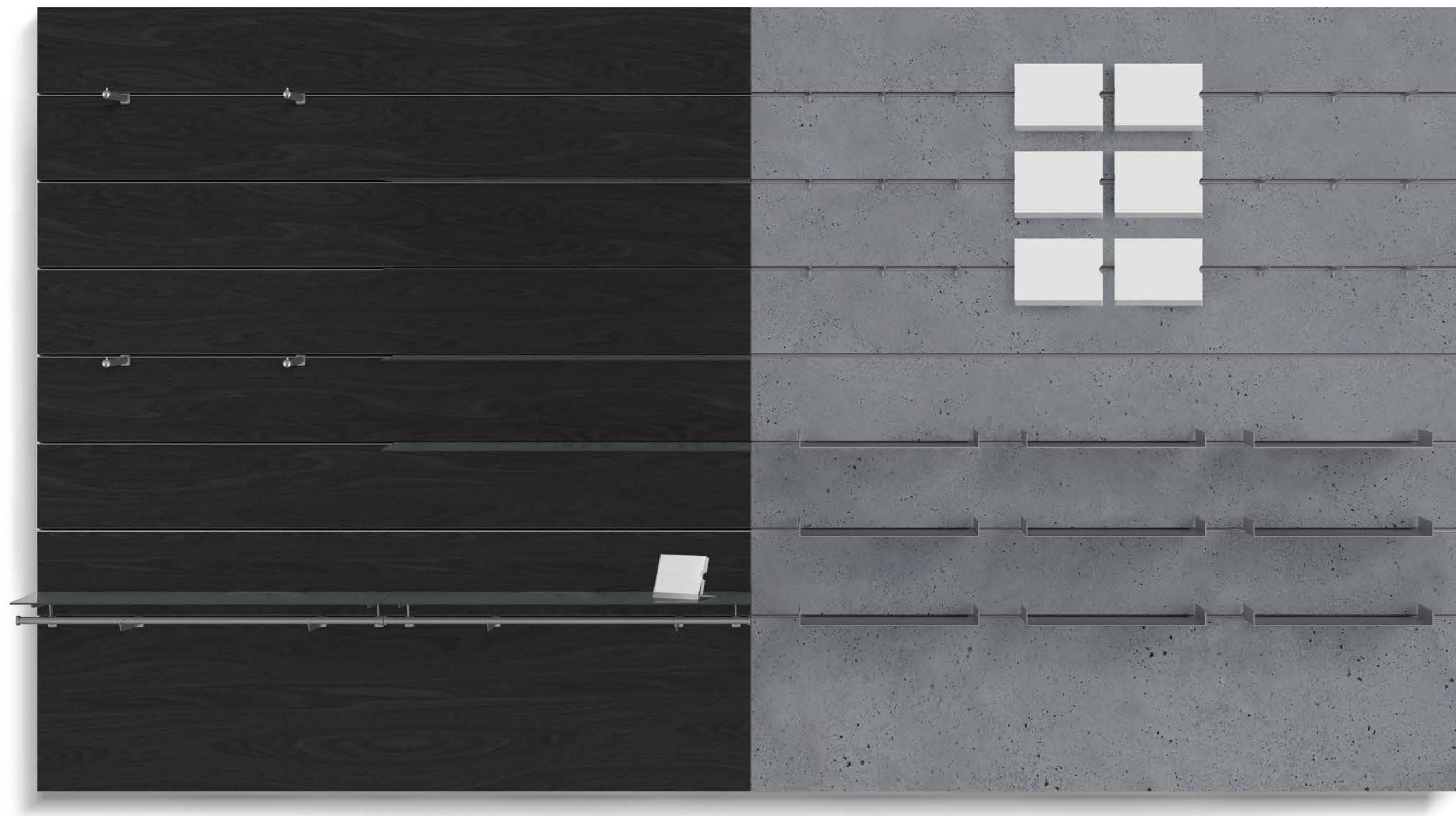

Non-electrified EH profiles with various standard accessories.

Non-electrified EH profiles with various standard accessories.

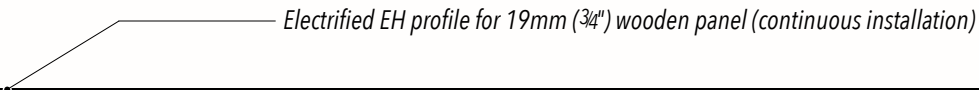
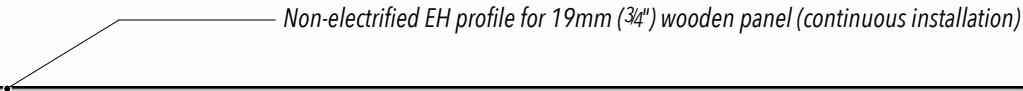
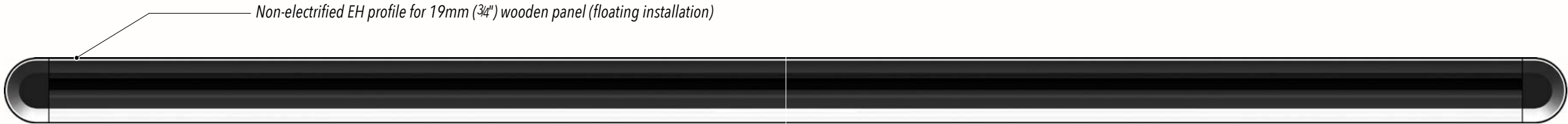

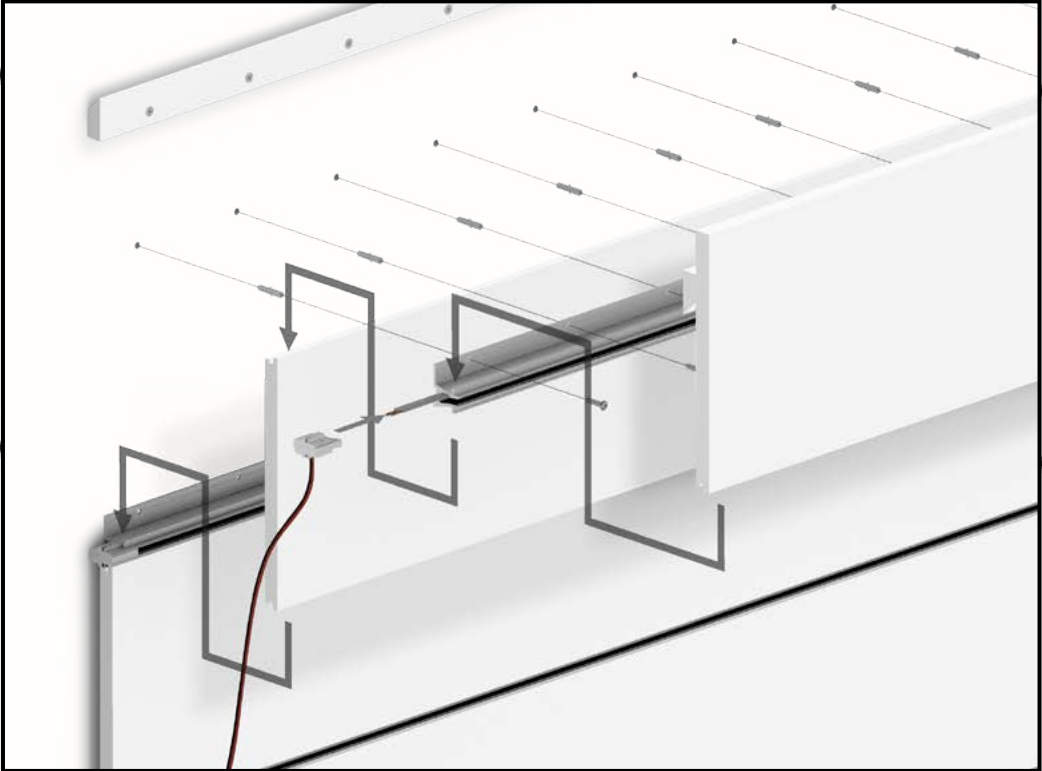

Electrified EH profile for 19mm (3/4") wooden panel (continuous installation)



Non-electrified EH profile for 19mm wooden panel (floating installation)

011 anodised

max 40kg
(85 lbs) per 625mm (1')

* End cap to be ordered separately.

Customised length PR-EH-454

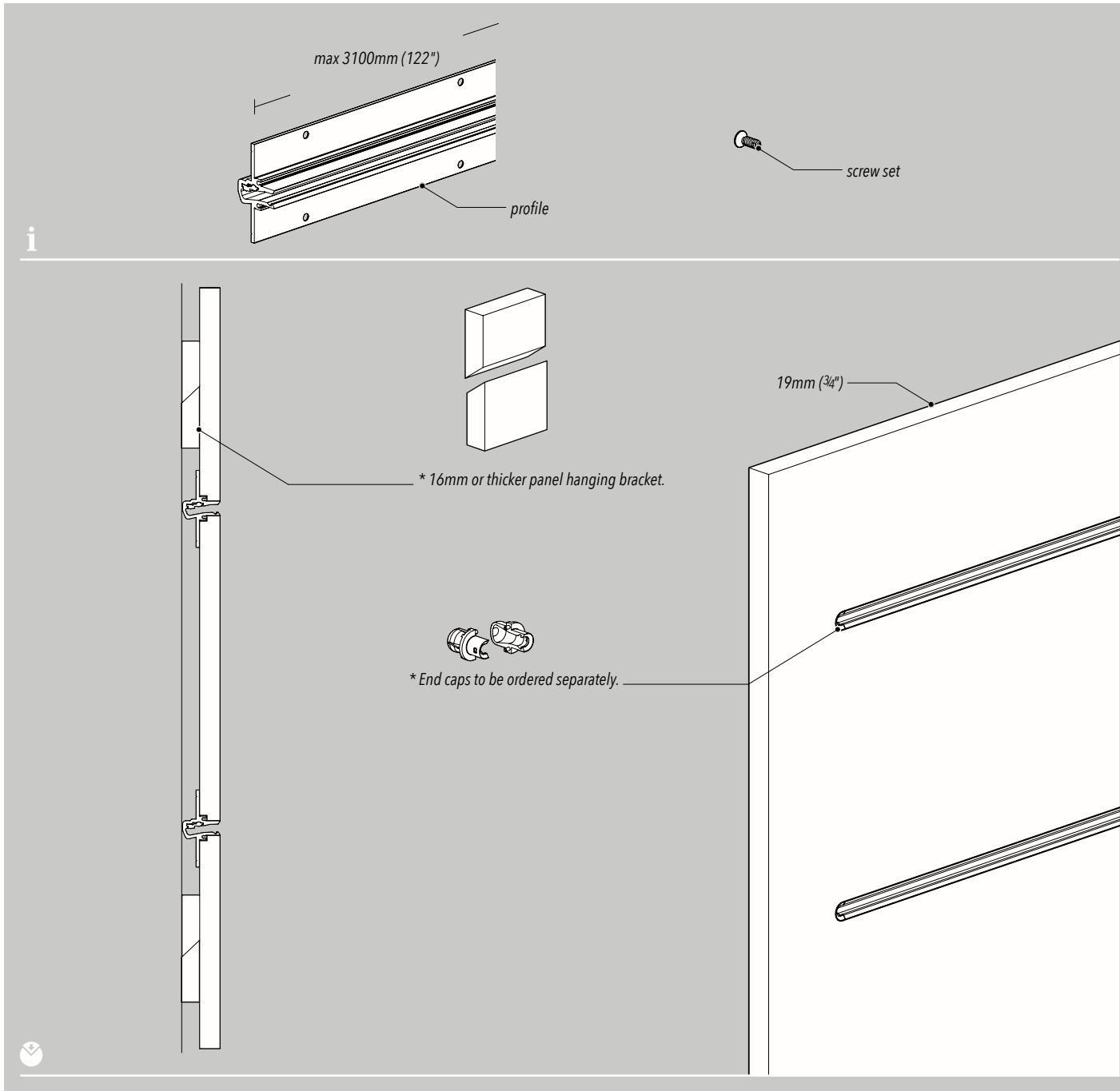

Electrified EH profile for 19mm wooden panel (floating installation)

011 anodised

max 40kg
(85 lbs) per 625mm (1')

* End cap & Power supply to be ordered separately.

Customised length PR-EH-455

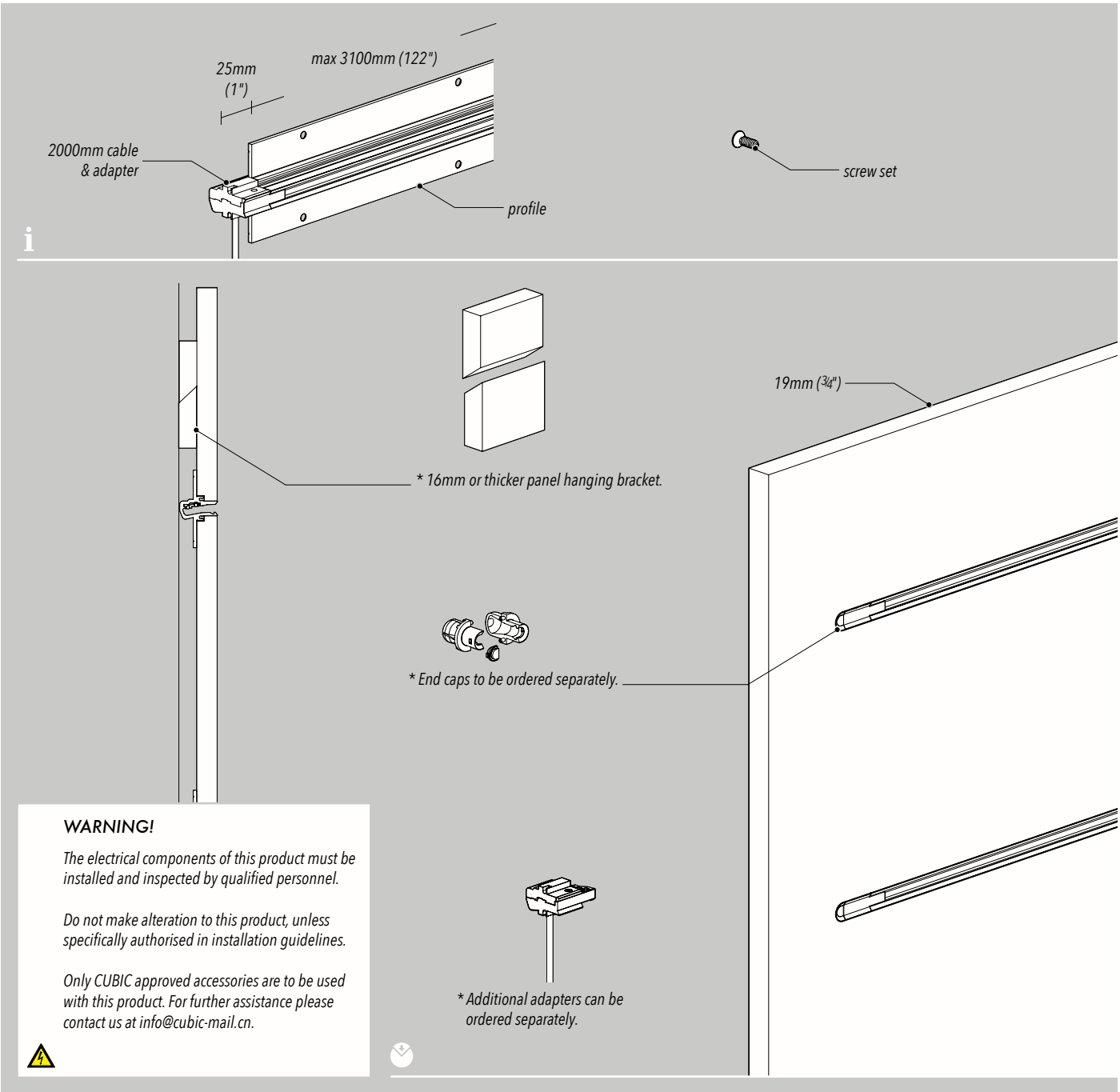



Non-electrified EH profile for 19mm wooden panel (continuous installation)

Electrified EH profile for 19mm wooden panel (continuous installation)

011 anodised

max 40kg
(85 lbs) per 625mm (1')

011 anodised

max 40kg
(85 lbs) per 625mm (1')

Customised length PR-EH-452

* Power supply to be ordered separately.

Customised length PR-EH-453

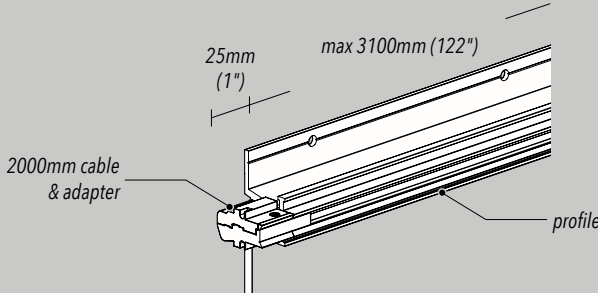
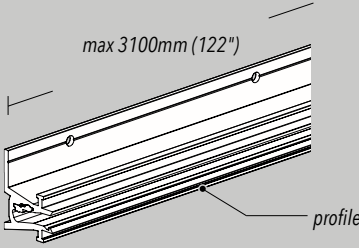

19mm (3/4")

* 19mm thick panel hanging brackets.

19mm (3/4")

* 19mm thick panel hanging brackets.

WARNING!
The electrical components of this product must be installed and inspected by qualified personnel.
Do not make alteration to this product, unless specifically authorised in installation guidelines.
Only CUBIC approved accessories are to be used with this product. For further assistance please contact us at info@cubic-mail.cn.

* Additional adapters can be ordered separately.



EH end cap for floating installation profile

008 satin silver



PR-EH-304

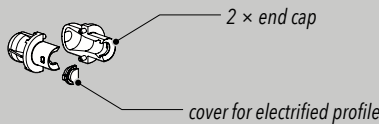

Adapter for Electrified EH profile

008 satin silver



PR-EH-101

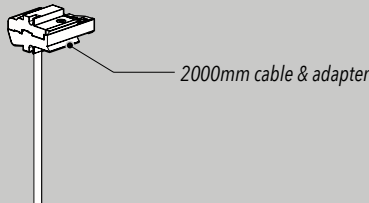

Cable-ready EH holder for 19mm wooden panel

021 satin chrome



×6

PR-EH-300

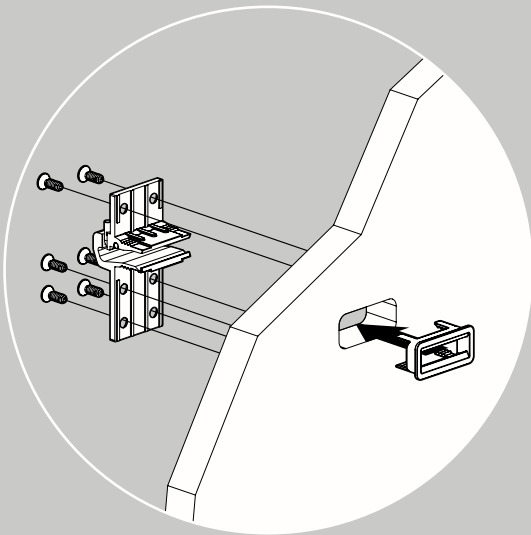
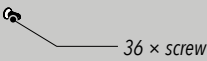
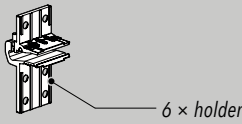

WARNING!
Electrifying this product must be done by qualified personnel.
Do not make alteration to this product, unless specifically authorised in installation guidelines.
Only CUBIC approved accessories are to be used with this product. For further assistance please contact us at info@cubic-mail.cn.





38mm Trax EH wooden shelf with LED



38mm Trax EH wooden shelf with LED PR-EH-513

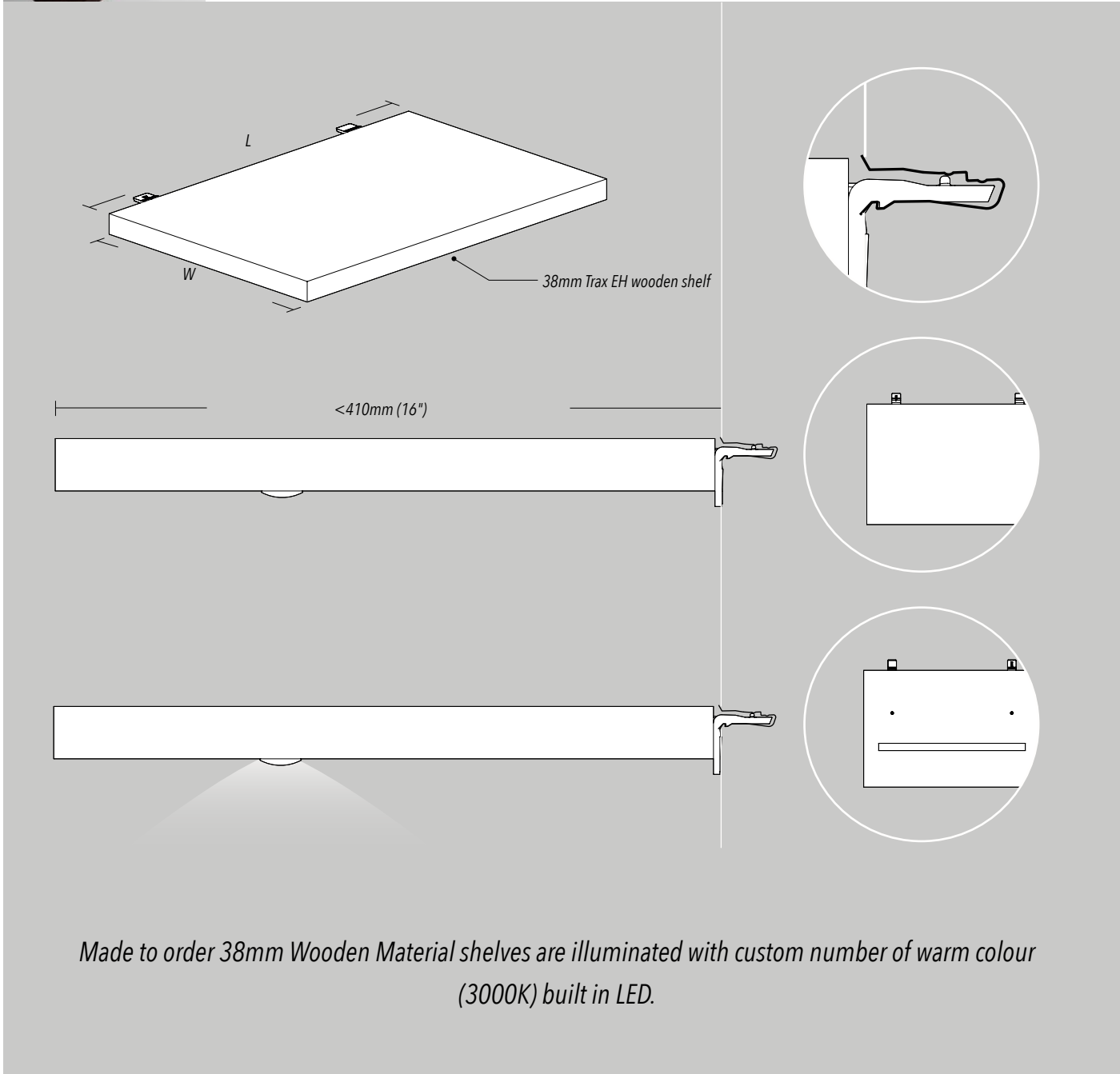

Made to order 38mm Wooden Material shelves are illuminated with custom number of warm colour (3000K) built in LED.

EH wooden shelf bracket with power adapter

019 plated

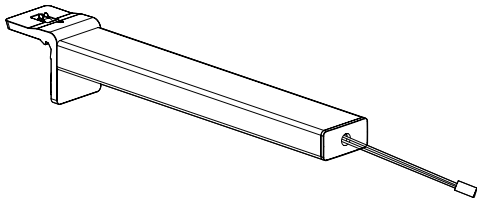

PR-EH-508

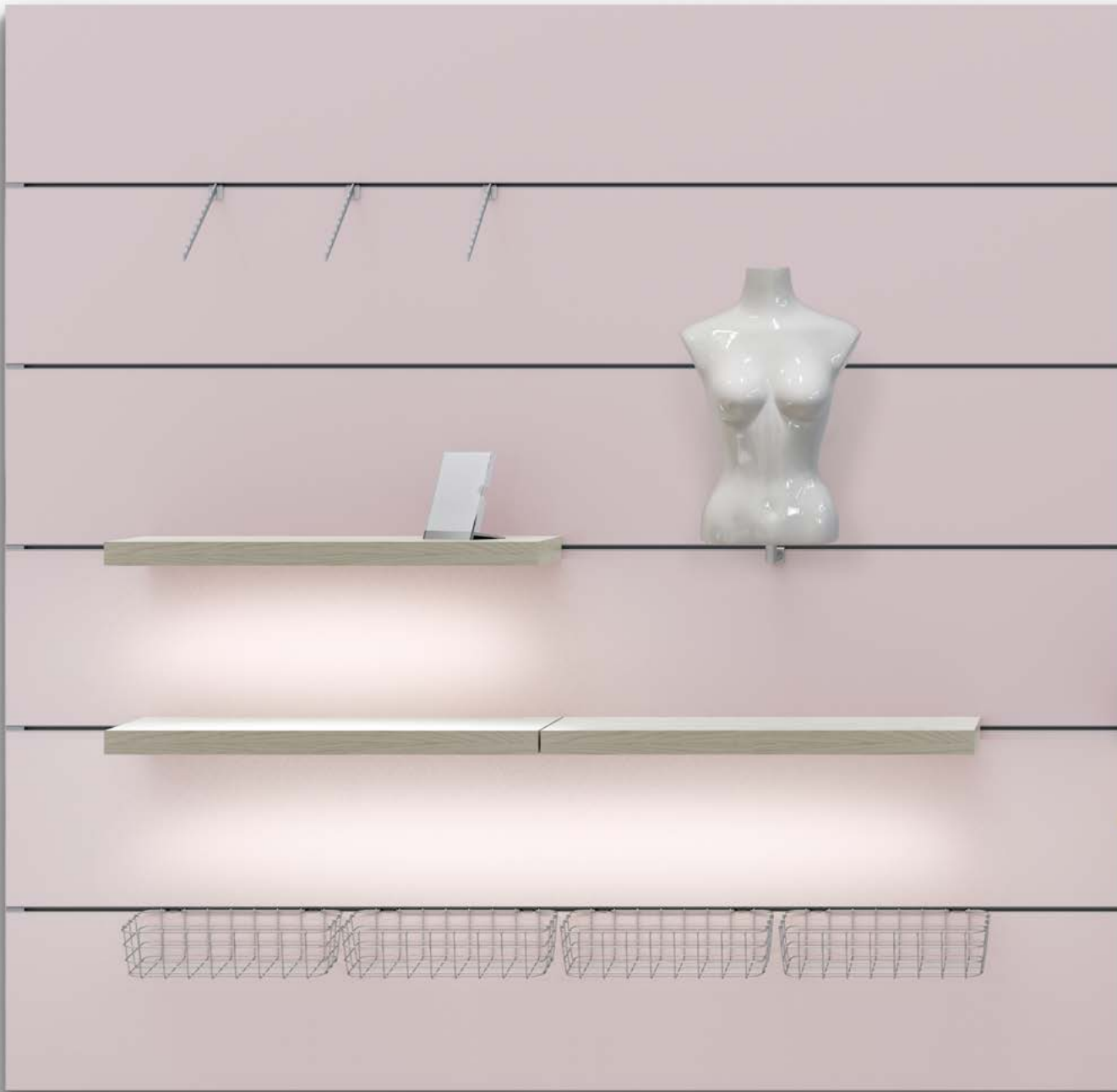

24 Volt electrified EH profiles with custom made illuminated wooden shelves with various standard accessories.

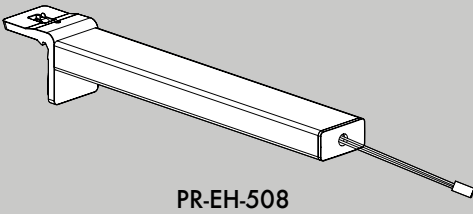

or



+

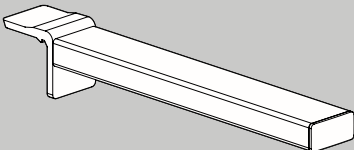

With the option of custom illuminated shelves

The Trax EH shelf power adapter allows for building custom illuminated shelves.
Contact us today for a discussion and receive suggestions and technical support on how to build a full custom illuminated shelf with the ease of plug and play.

WARNING!

- Power supply voltage not to exceed 24 volts.
- The electrical components of this product must be installed and inspected by qualified personnel.
- Do not make alteration to this product, unless specifically authorised in installation guidelines.
- Only CUBIC approved accessories are to be used with this product. For further assistance please contact us at info@cubic-mail.cn.

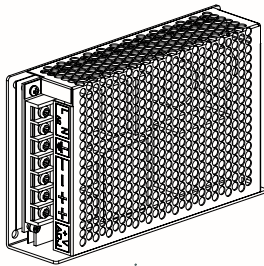

EH shelf power adapter

006 grey



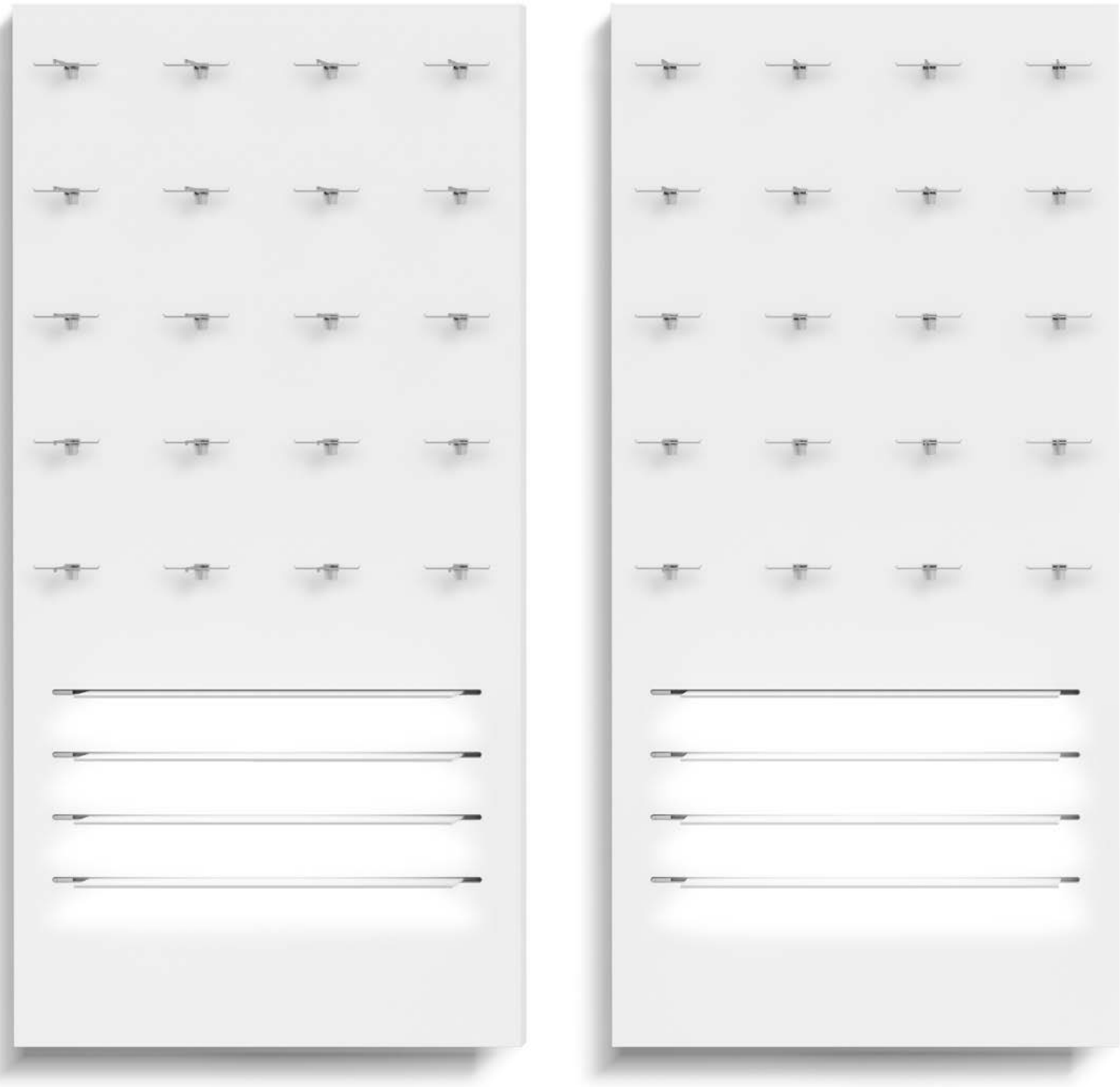

EH holders with EH eye wear holders and 24 Volt electrified EH profiles with made to order 6mm Glass illuminated shelves.

6mm Trax EH glass shelf

040 clear

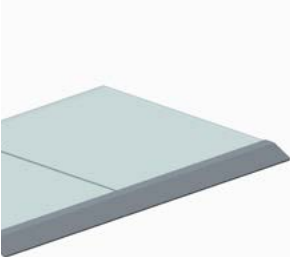

6mm Trax EH glass shelf with LED CP-JLR-004

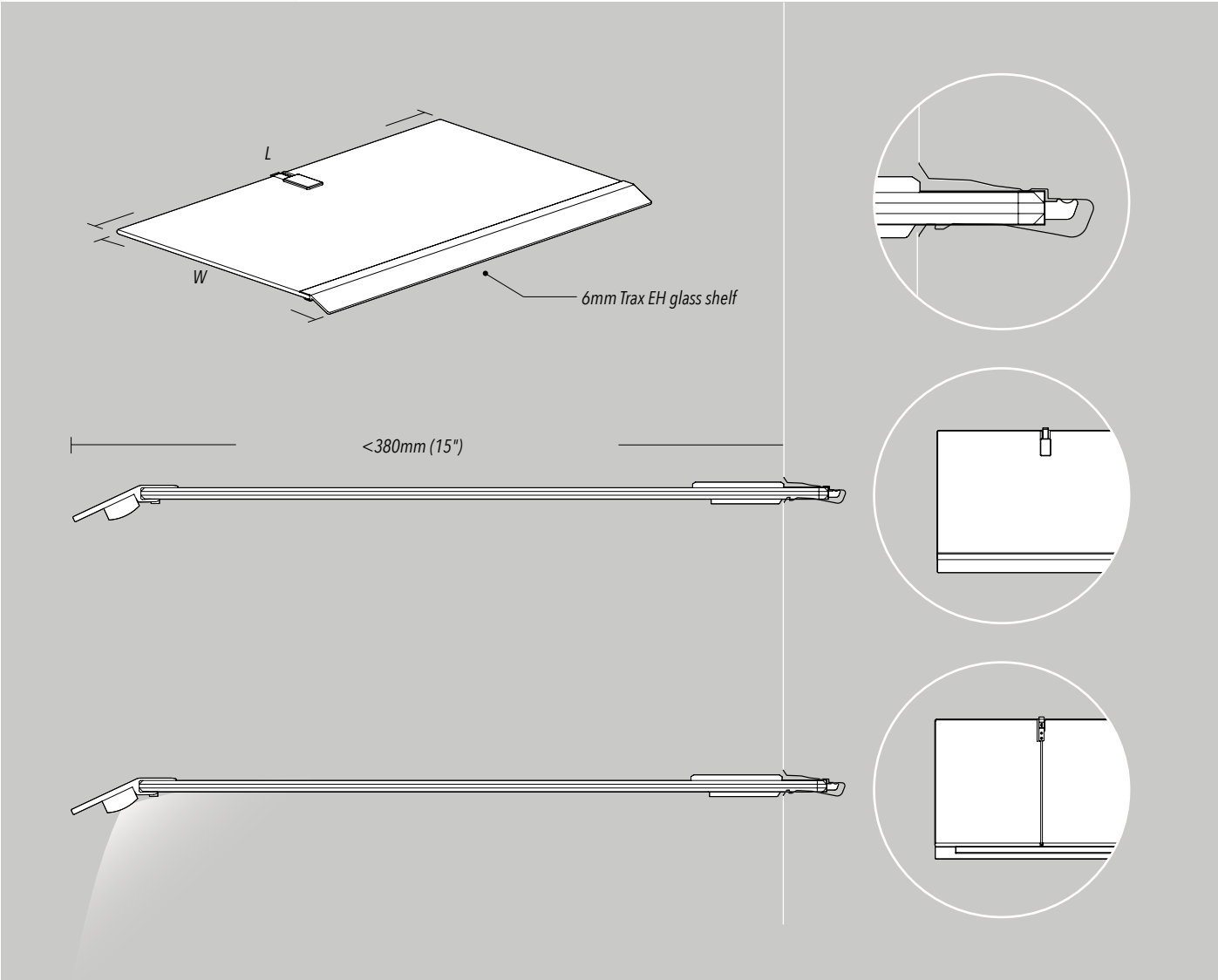

Made to order 6mm Tempered Glass Material shelves are illuminated with custom number of warm colour (3000K) built in LED.

Made to order

EH power supply for Trax EH shelf with LED

000 no finish specified

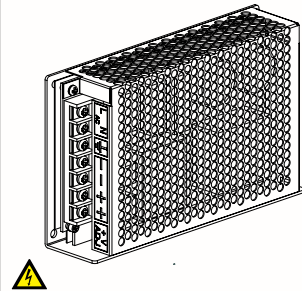

- * A single power supply can be used to power up to 3 profiles.
- * The total length of profiles powered by a single power supply must not exceed 3000mm.
- * A distribution box is required (not included) for powering multiple profiles.
- * Power cord included.
- * Input: 100-240V 50-60 Hz
- * Output Voltage nom: 24 V DC
- * Output Current max: 5000 mA

24 V DC / 5000 mA PR-TR-569

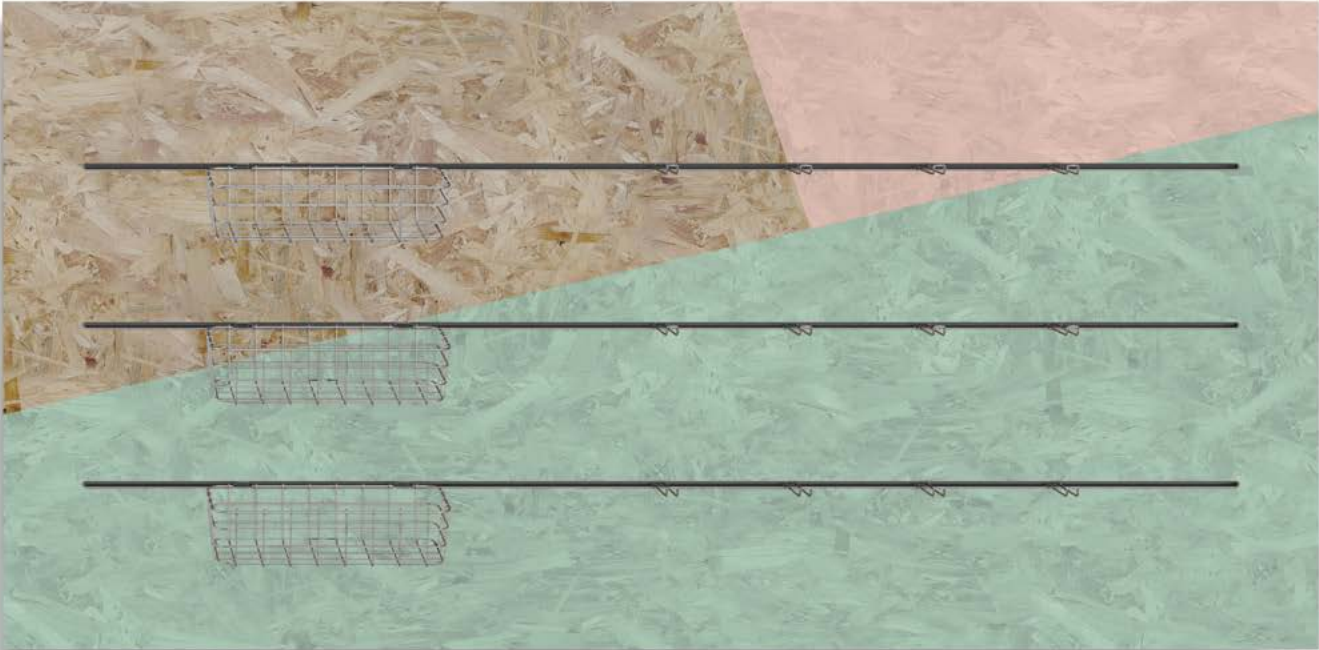
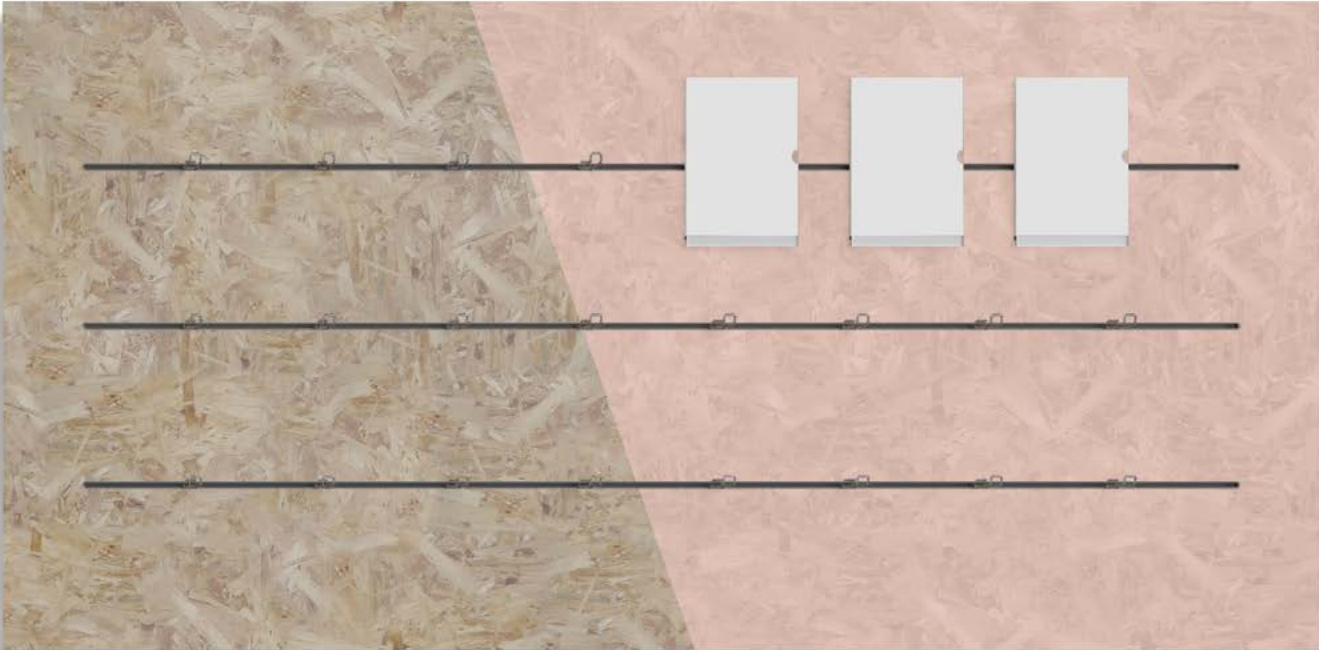

Non-electrified EH profiles with various standard accessories.

6mm glass shelf

- 040 clear
- 041 frosted

max 20kg
(40 lbs) per shelf

620×330mm	PR-TR-369	23 ⁷ / ₈ " × 13"	PR-TR-906
620×410mm	PR-TR-033	23 ⁷ / ₈ " × 16.14"	PR-TR-907
1245×330mm	PR-TR-370	47 ⁷ / ₈ " × 13"	PR-TR-908
1245×410mm	PR-TR-350	47 ⁷ / ₈ " × 16.14"	PR-TR-909
1870×330mm	PR-TR-371	71 ⁷ / ₈ " × 13"	PR-TR-910
1870×410mm	PR-TR-351	71 ⁷ / ₈ " × 16.14"	PR-TR-911

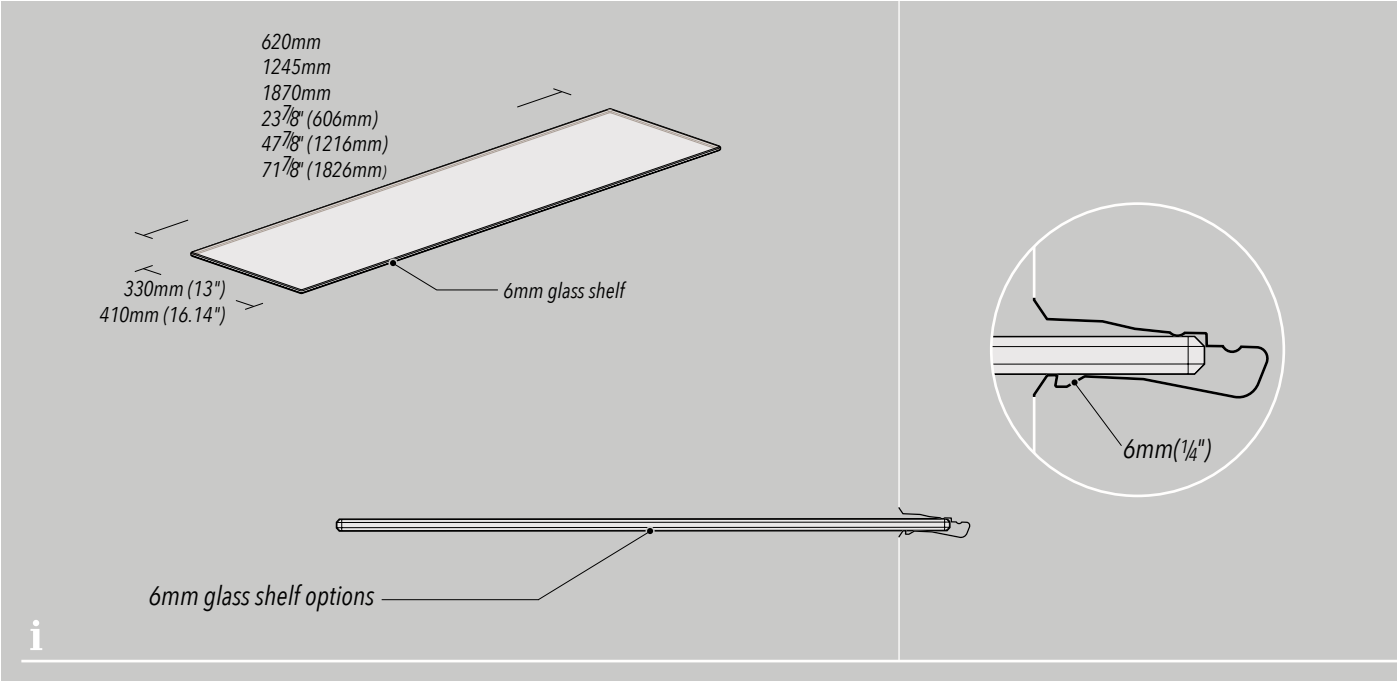

3mm aluminium shelf for EH profiles

- 011 anodised

max 10kg
(20 lbs) per shelf

PR-EH-318

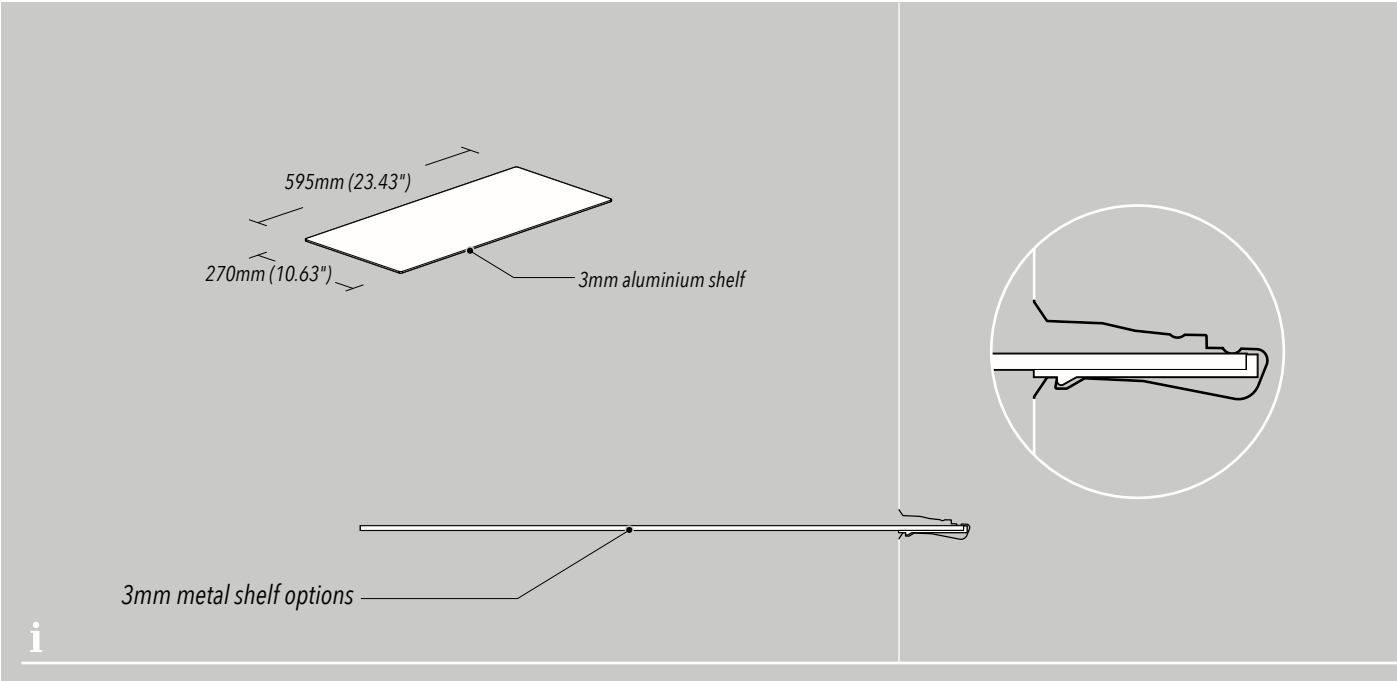



3mm aluminium shelf with ends for EH profiles

011 anodised

max 10kg
(20 lbs) per shelf

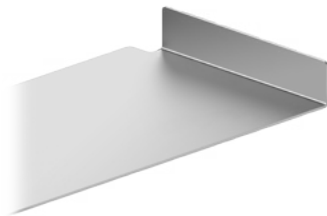

PR-EH-319

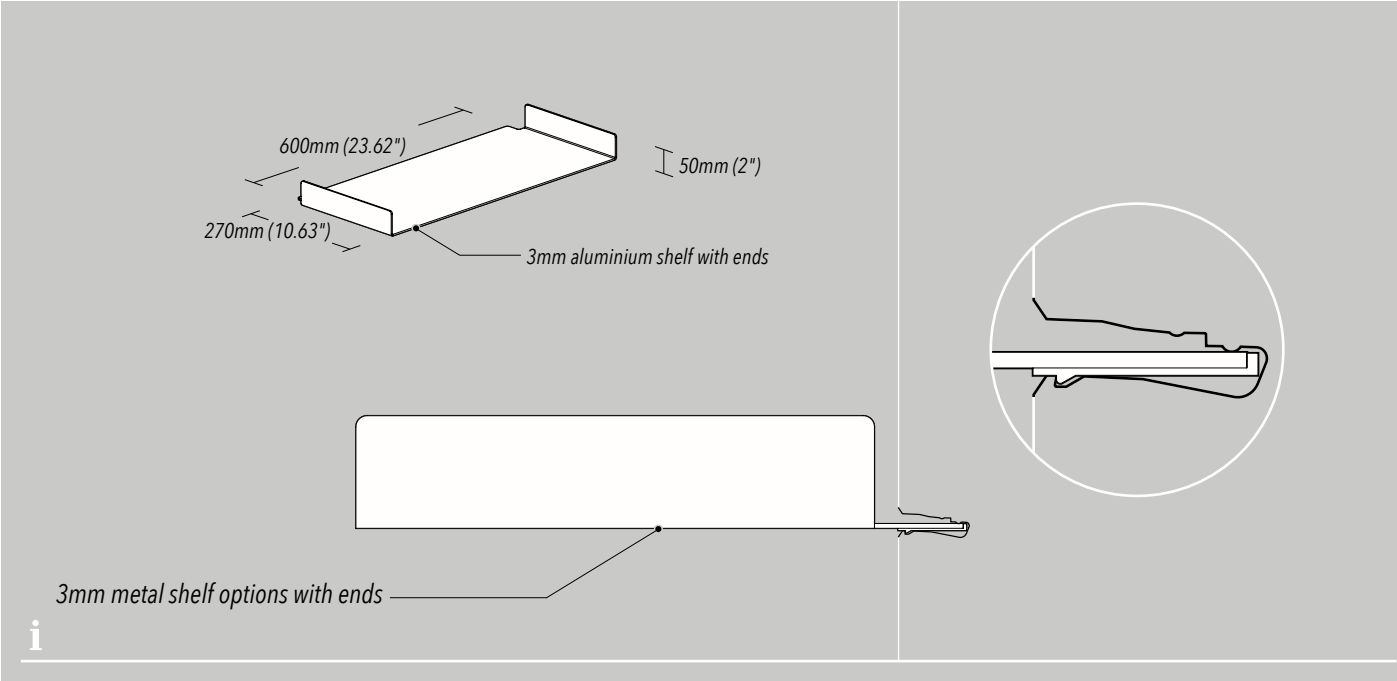

EH shelf bracket

021 satin chrome

max 15kg
(30 lbs) per bracket



* For use with max 380mm deep shelf.

PR-EH-321

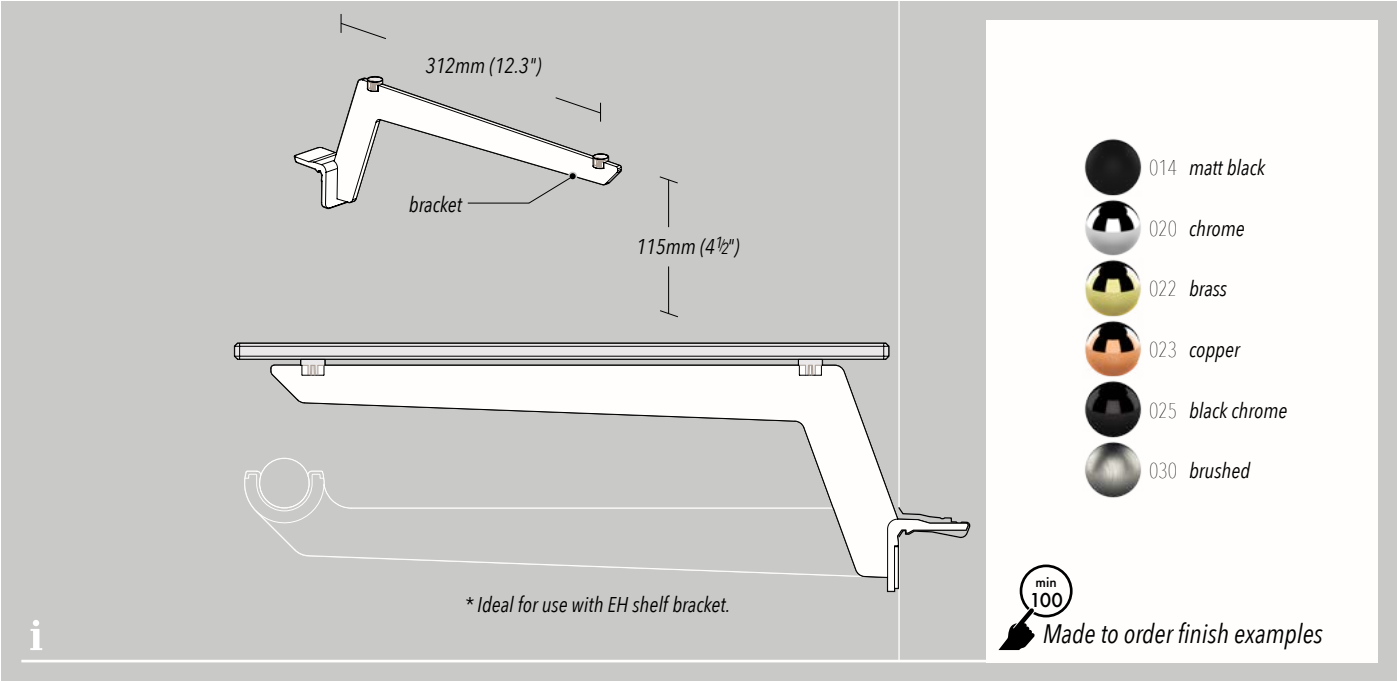

EH wooden shelf bracket

019 plated

max 15kg
(30 lbs) per bracket



* Wooden shelf not supplied.

PR-EH-334

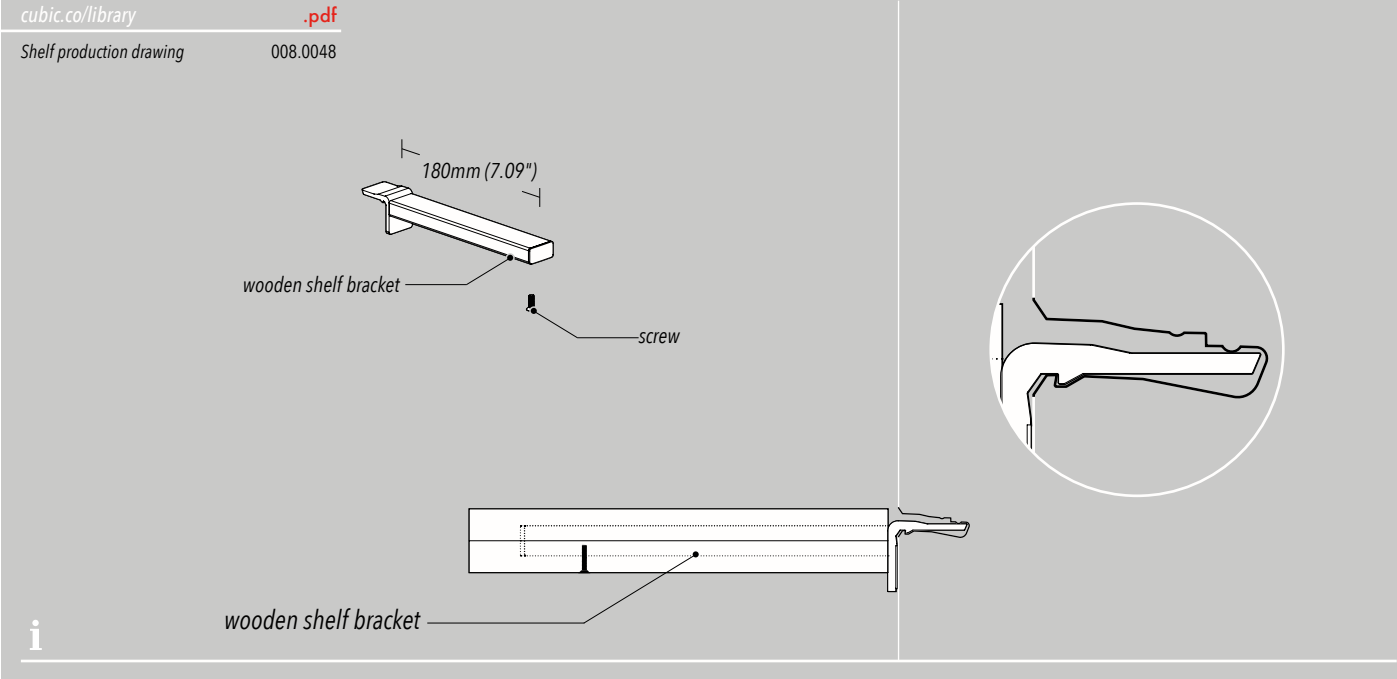

8mm glass shelf

040 clear
041 frosted

max 25kg
(55 lbs) per shelf



* For use with EH shelf bracket.

620×330mm PR-FL-315	23 7/8"×13" PR-FL-900
620×380mm PR-FL-141	23 7/8"×15" PR-FL-901
1245×330mm PR-FL-316	47 7/8"×13" PR-FL-902
1245×380mm PR-FL-143	47 7/8"×15" PR-FL-903
1870×330mm PR-FL-317	71 7/8"×13" PR-FL-904
1870×380mm PR-FL-318	71 7/8"×15" PR-FL-905

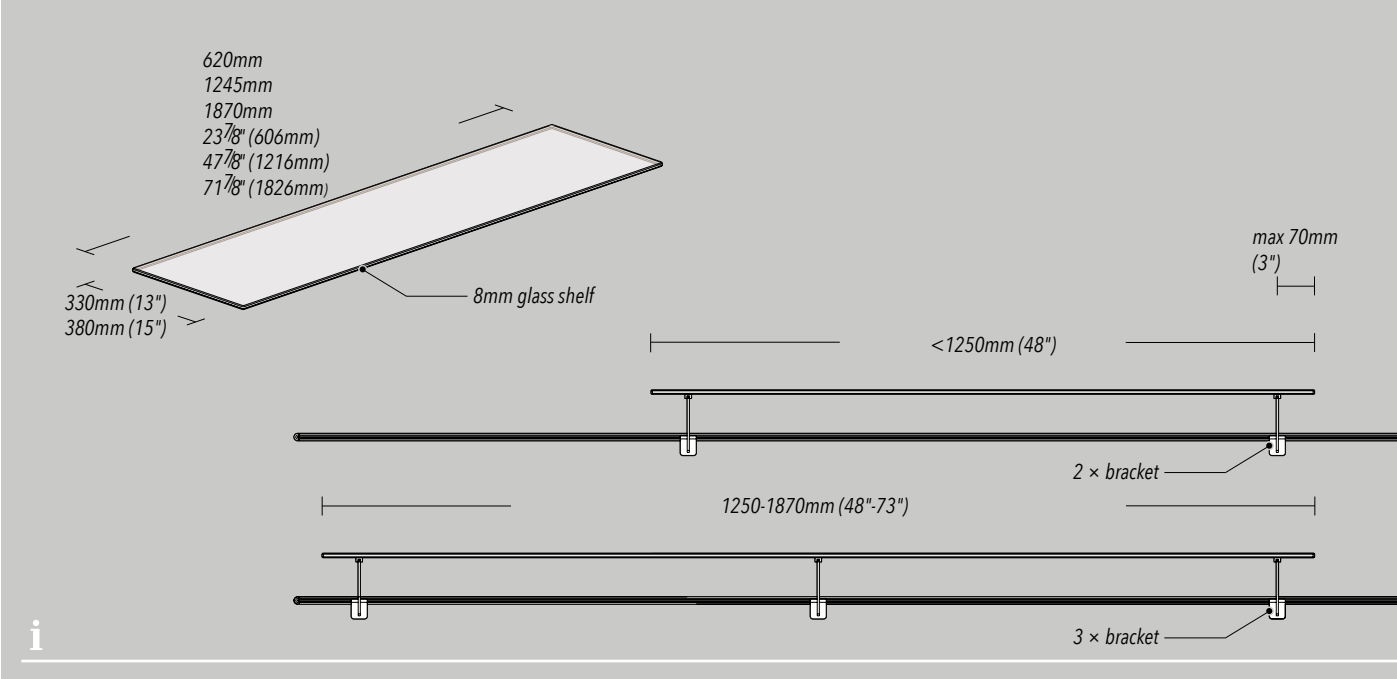



EH hang rail bracket



021 satin chrome

max 15kg
(30 lbs) per bracket

* For use with Ø25mm hang rail.

PR-EH-324

305mm (12")

bracket

* Ideal for use with EH shelf bracket.

- 014 matt black
- 020 chrome
- 022 brass
- 023 copper
- 025 black chrome
- 030 brushed

min 100
Made to order finish examples

Ø25mm hang rail



020 chrome
021 satin chrome

1245mm PR-TR-091 47⁷/₈" PR-TR-900
1870mm PR-TR-333 71⁷/₈" PR-TR-901

1245mm
1870mm
47⁷/₈" (1216mm)
71⁷/₈" (1826mm)

Ø25mm hang rail

<1250mm (48")

2 × bracket

1250-1870mm (48"-73")

3 × bracket

max 1870mm (73")

Ø25mm hang rail

Customised length PR-TR-090

- 014 matt black
- 020 chrome
- 022 brass
- 023 copper

min 50
Made to order finish examples

EH straight front arm (Ø25mm)



021 satin chrome

max 20kg
(40 lbs) per arm

300mm PR-EH-322

300mm (12")

Ø25mm (1") arm

100mm (4")
200mm (8")

Ø25mm (1") arm

100mm PR-EH-450
200mm PR-EH-451

min 100
Made to order options

min 100
Made to order finish examples

- 014 matt black
- 020 chrome
- 022 brass
- 023 copper
- 025 black chrome
- 030 brushed

EH stepped front arm (Ø25mm)



021 satin chrome

max 20kg
(40 lbs) per arm

PR-EH-323

300mm (12")

Ø25mm (1") arm

125mm (5")

min 100
Made to order finish examples

- 014 matt black
- 020 chrome
- 022 brass
- 023 copper



EH, Physiqx bracket (Ø25mm)

- 021 satin chrome

max 15kg
(30 lbs) per bracket

* For use with Torso.

PR-EH-325

- 014 matt black
- 020 chrome
- 022 brass
- 023 copper

min 100
Made to order finish examples

Ø25mm sign holder clip

- 002 transparent



×10

* Sign holder to be ordered separately.

PR-FL-321

Female torso

- 090 silver (RAL 9006)
- 100 gloss white (RAL 9003S)
- 200 gloss black (RAL 9005S)



PR-PH-012

Male torso

- 090 silver (RAL 9006)
- 100 gloss white (RAL 9003S)
- 200 gloss black (RAL 9005S)



PR-PH-013

A8L sign holder

- 002 transparent



×10

PR-RA-151

A7L sign holder

- 002 transparent



×10

PR-RA-150



EH, Index bracket

000 no finish specified



PR-EH-332

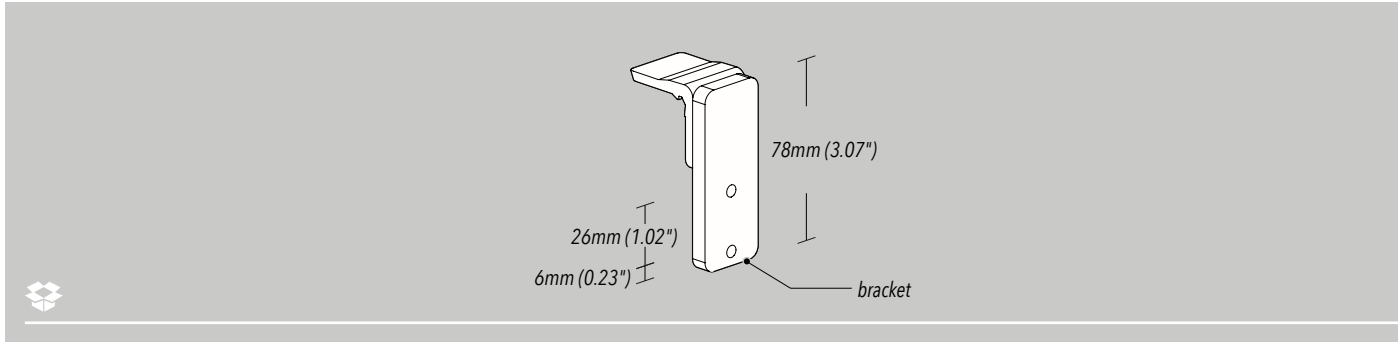

Index multi-system sign holder

100 gloss white

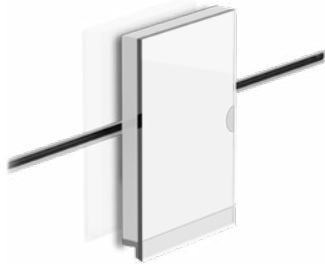

*Sign holder bracket to be ordered separately.

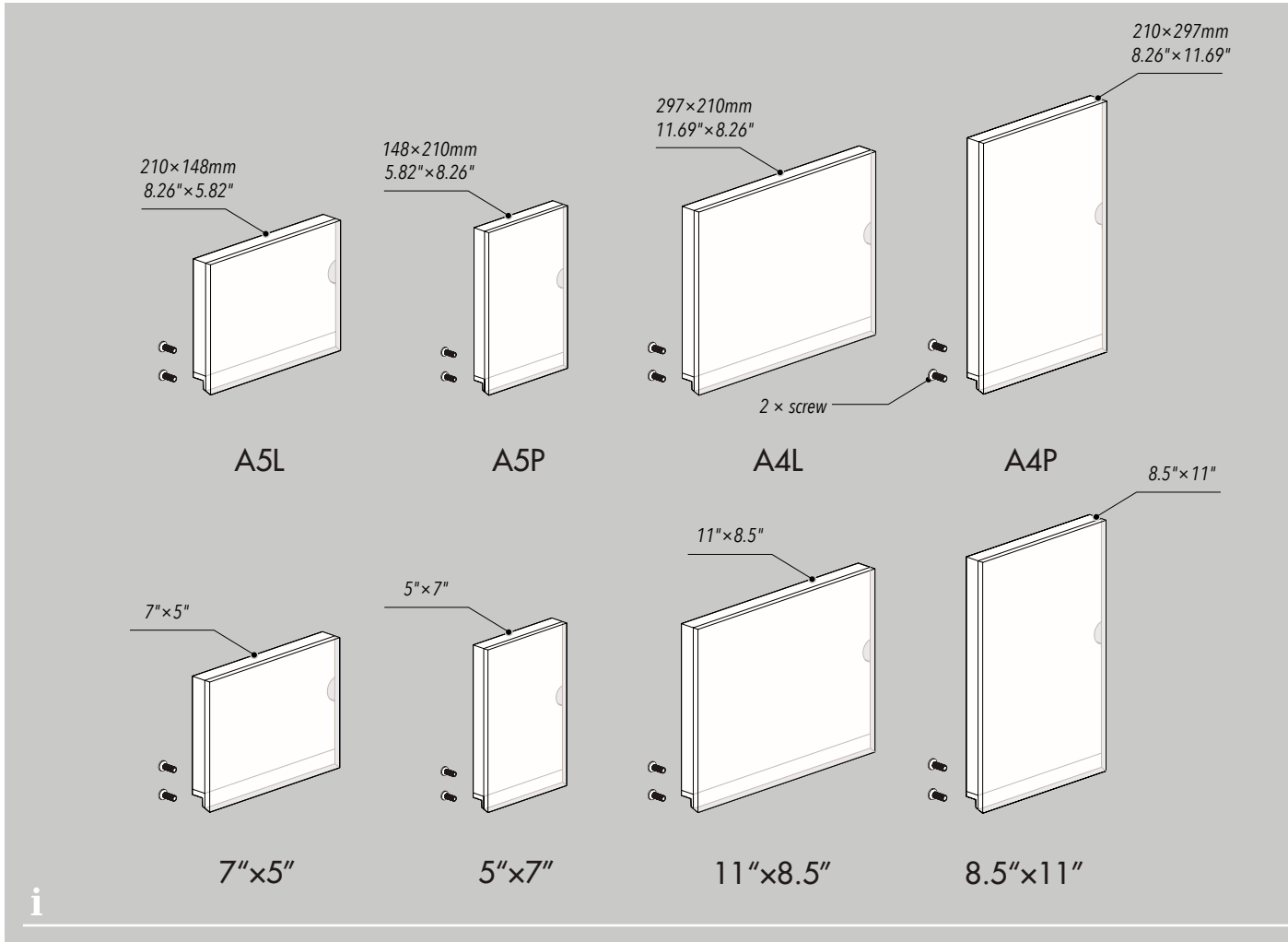

EH prong

021 satin chrome



max 3kg
(6 lbs) per prong

PR-EH-326

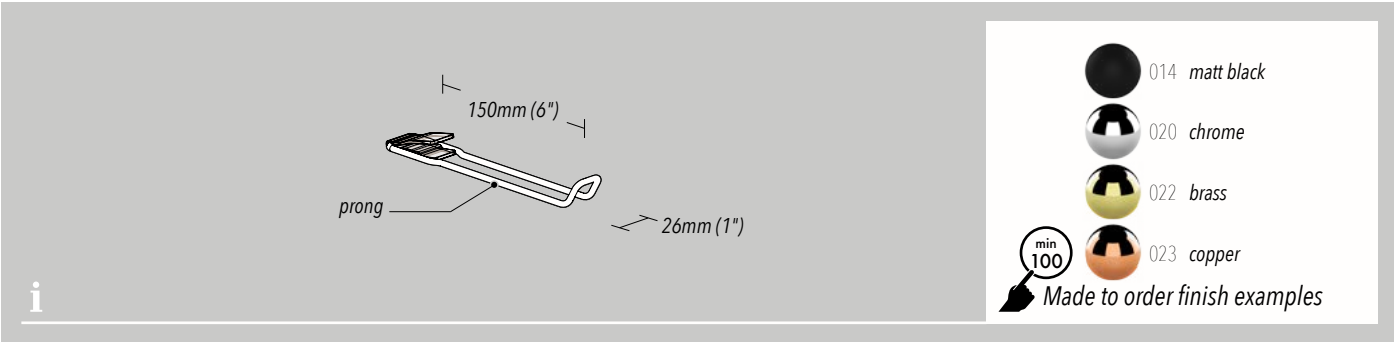

EH hook

021 satin chrome



max 8kg
(16 lbs) per hook

PR-EH-327

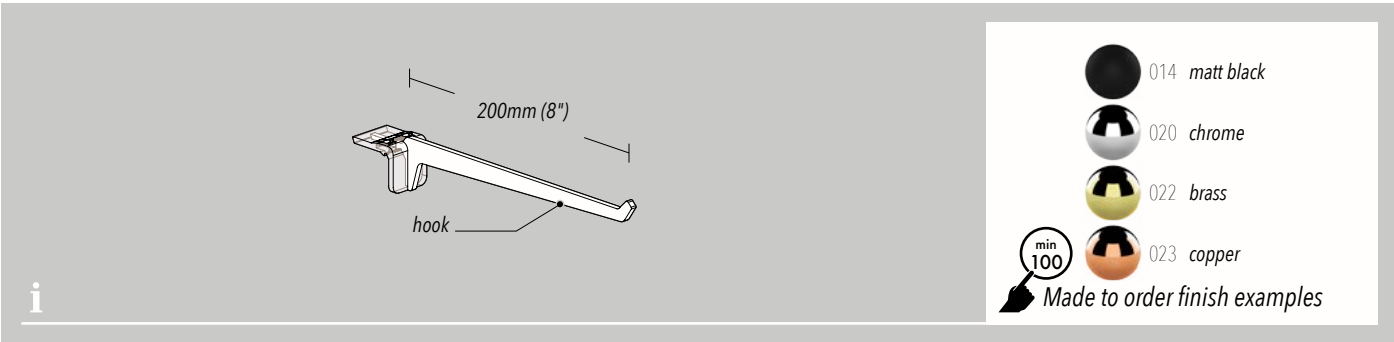

EH angled hook

021 satin chrome



max 8kg
(16 lbs) per hook

PR-EH-328

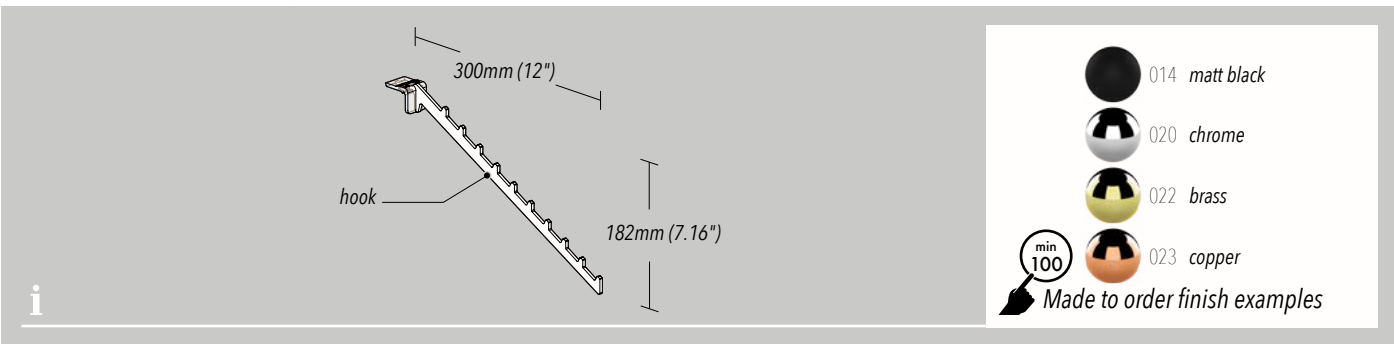



EH eyewear holder



021 satin chrome

kg max 1kg
(2 lbs) per holder

PR-EH-329

eyewear holder

014 matt black

020 chrome

022 brass

023 copper

min 100

Made to order finish examples

EH lightweight hook



002 transparent

kg max 1kg
(2 lbs) per holder

PR-EH-333

20 × hook

014 matt black

020 chrome

022 brass

023 copper

min 100

Made to order finish examples

EH basket



021 satin chrome

kg max 10kg
(20 lbs) per basket

PR-EH-330

basket

014 matt black

020 chrome

022 brass

023 copper

min 50

Made to order finish examples

EH & H6 panel holder

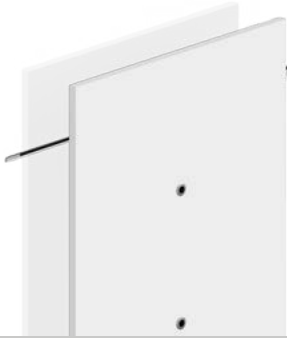

011 anodised

kg max 75kg
(160 lbs) per holder

PR-EH-457

panel holder

1

2

3

panel bracket bracket

panel spacer

26mm (>1")

Panel holder bracket



010 matt silver

PR-TR-379

Panel spacer



010 matt silver

PR-TR-481



EH demo box

000 no finish specified



EX-MA-430

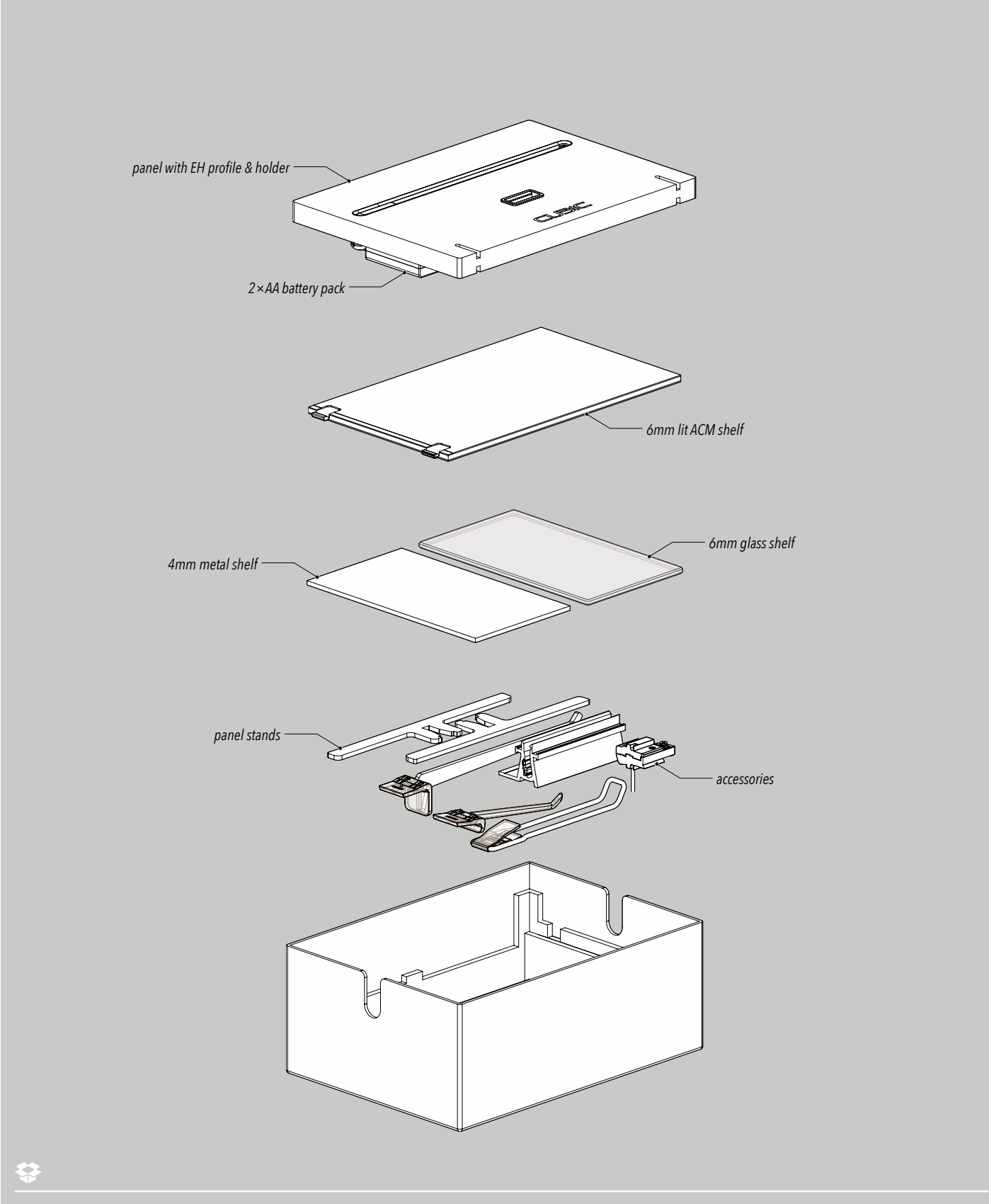

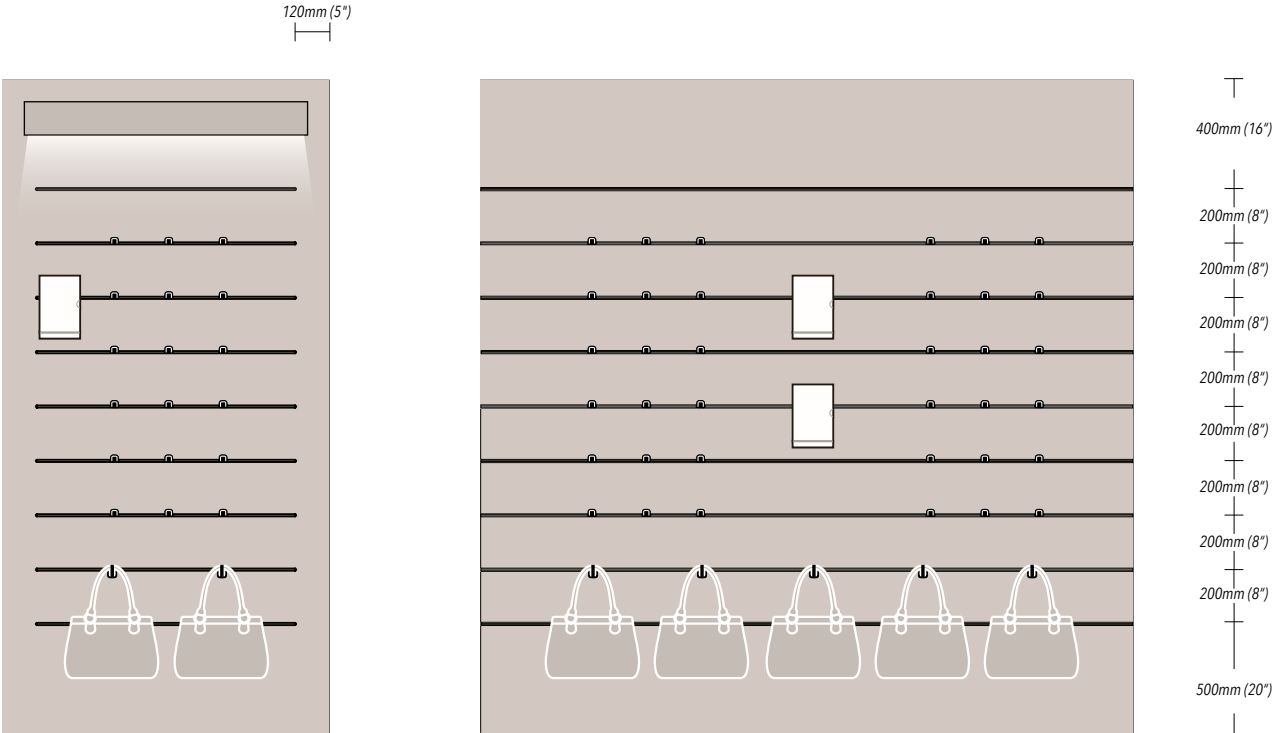

A

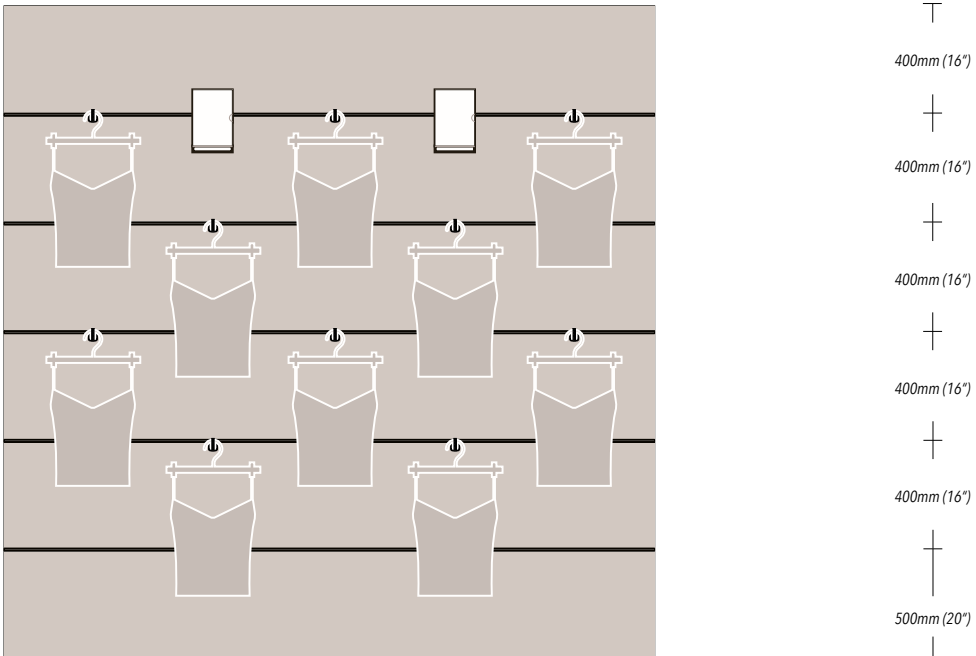

C

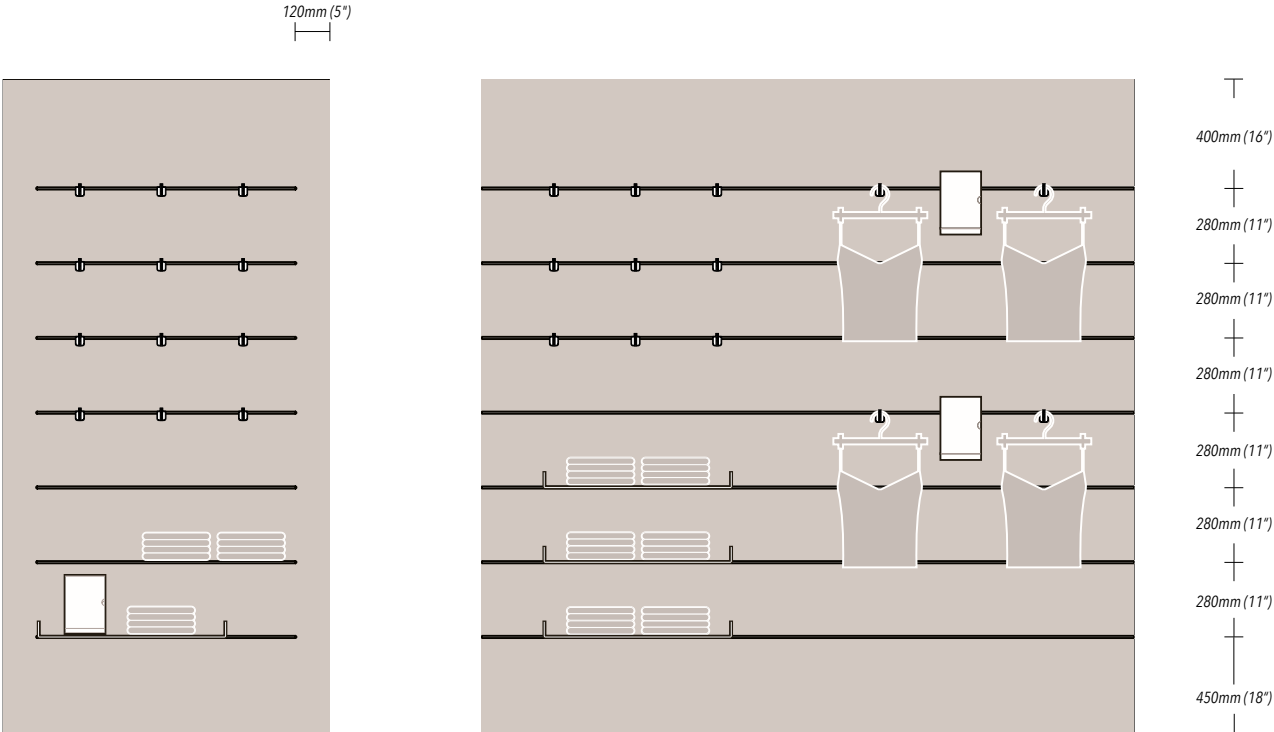

B

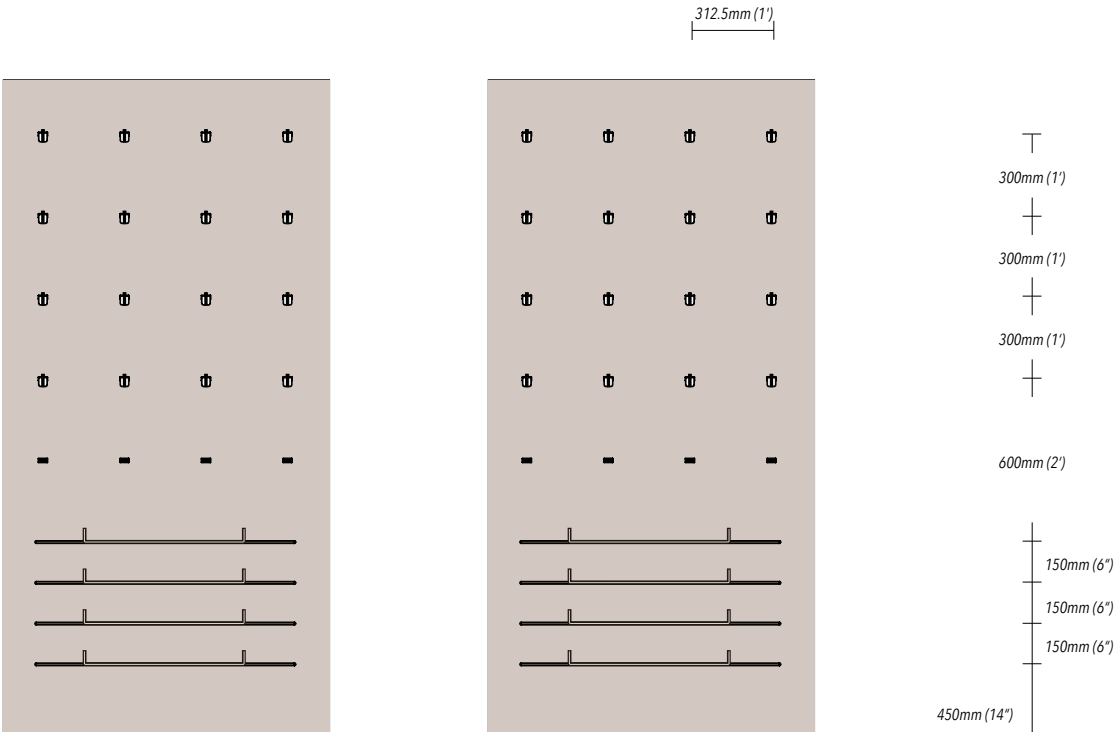

D

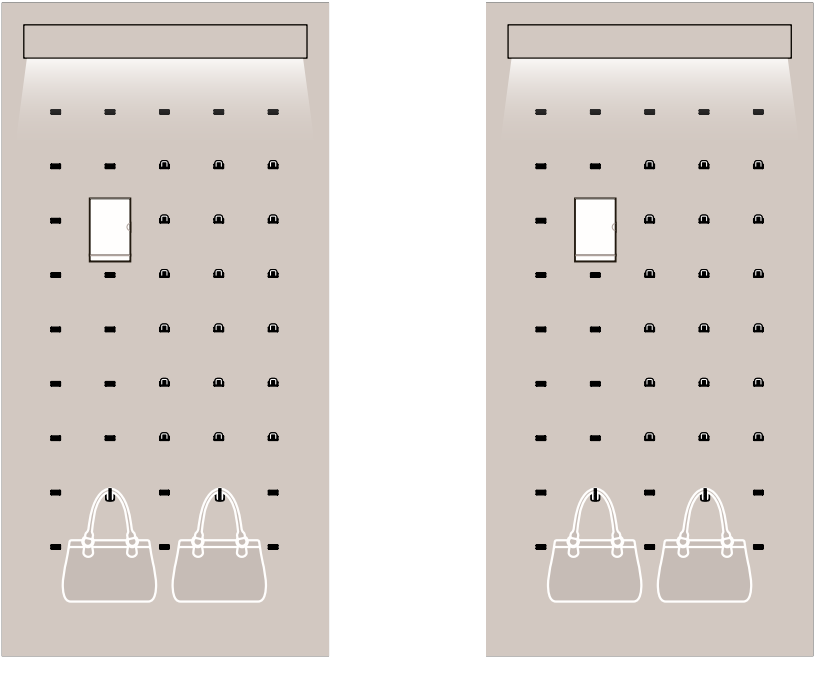
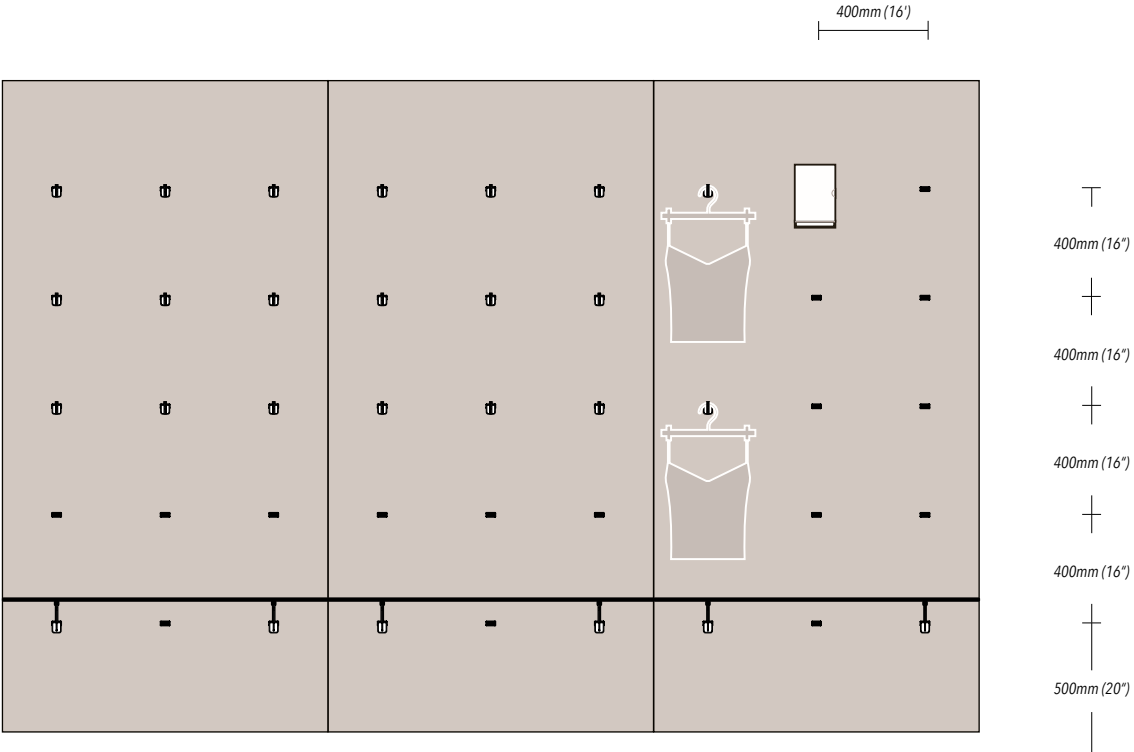
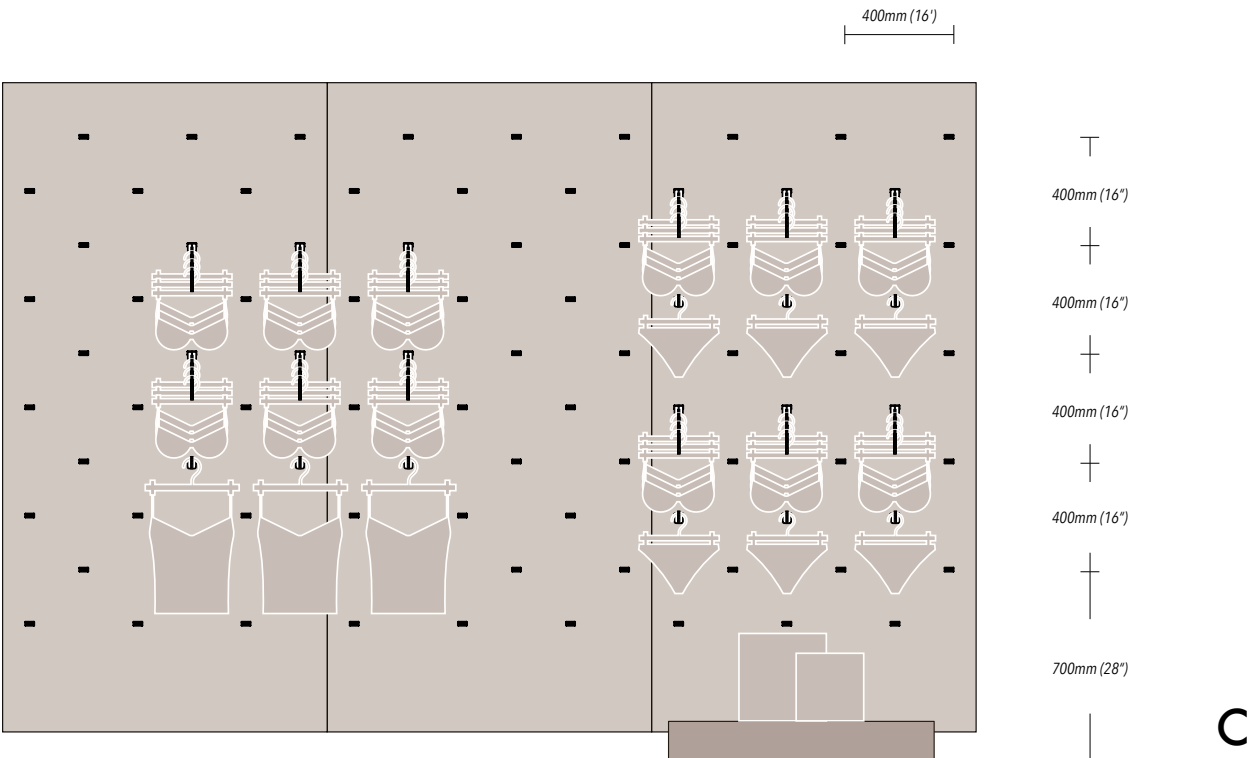
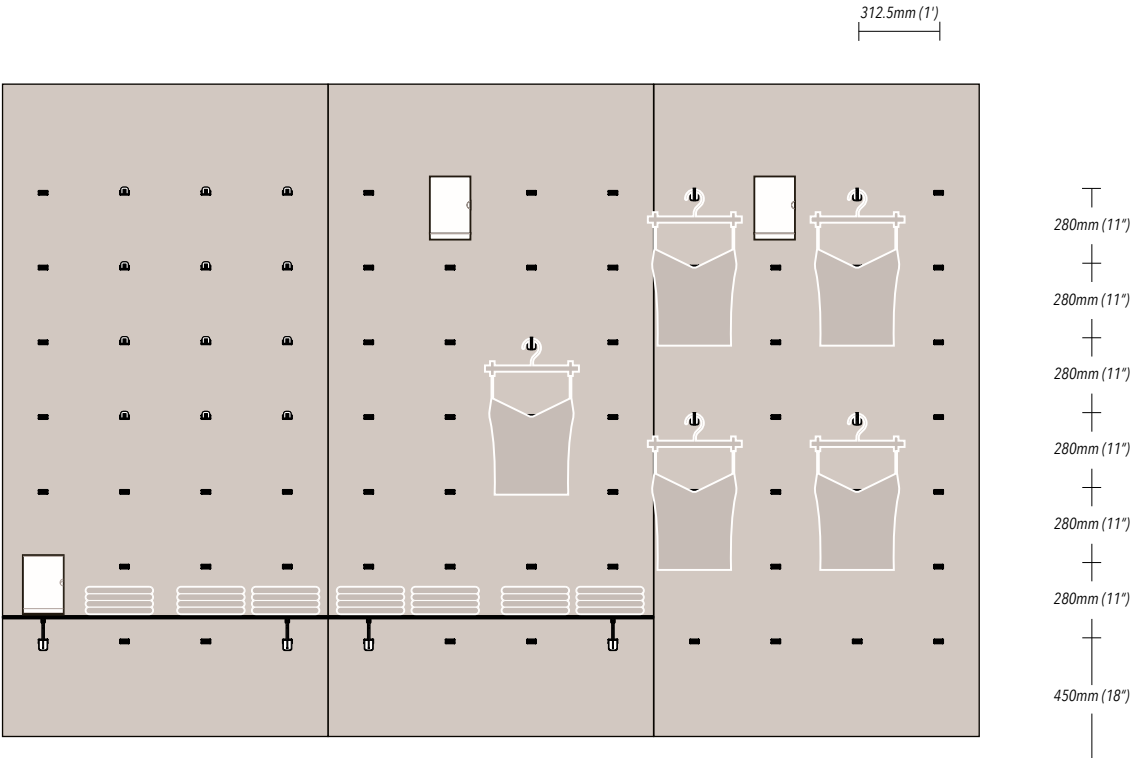

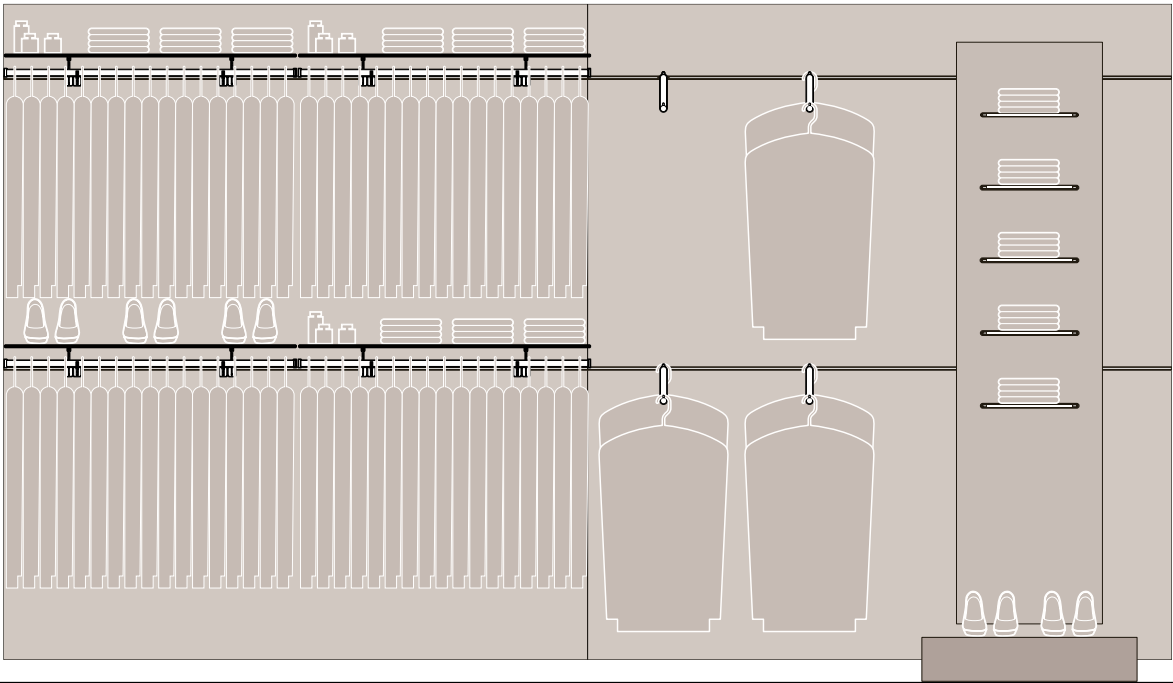

A

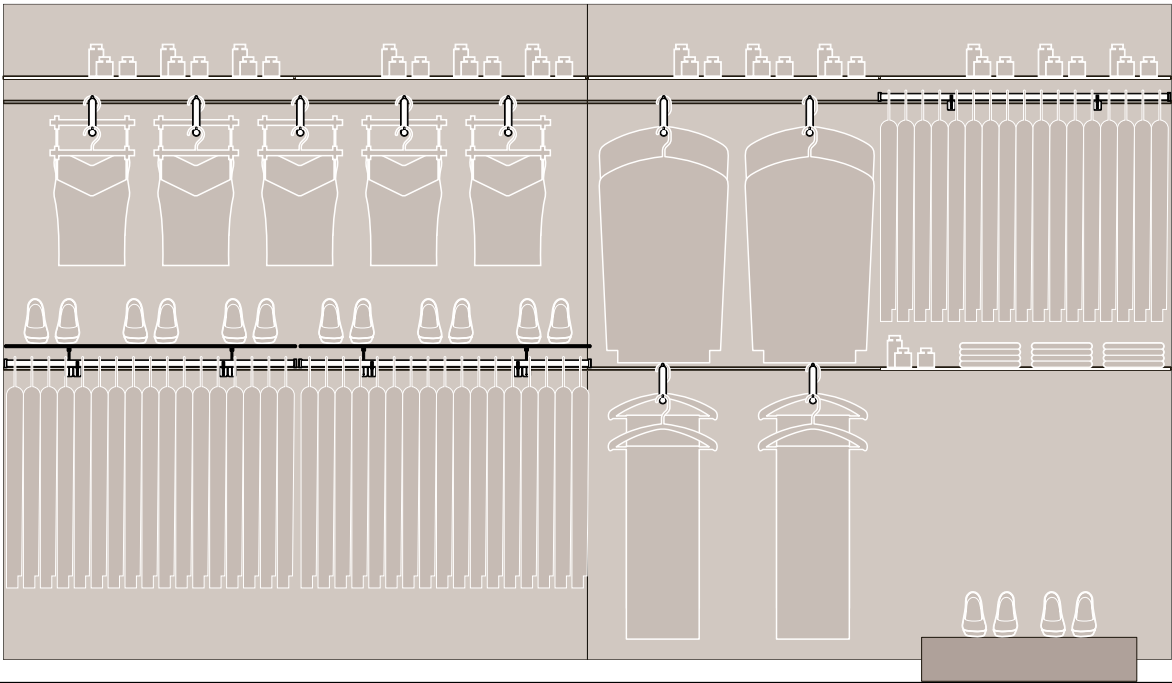

C

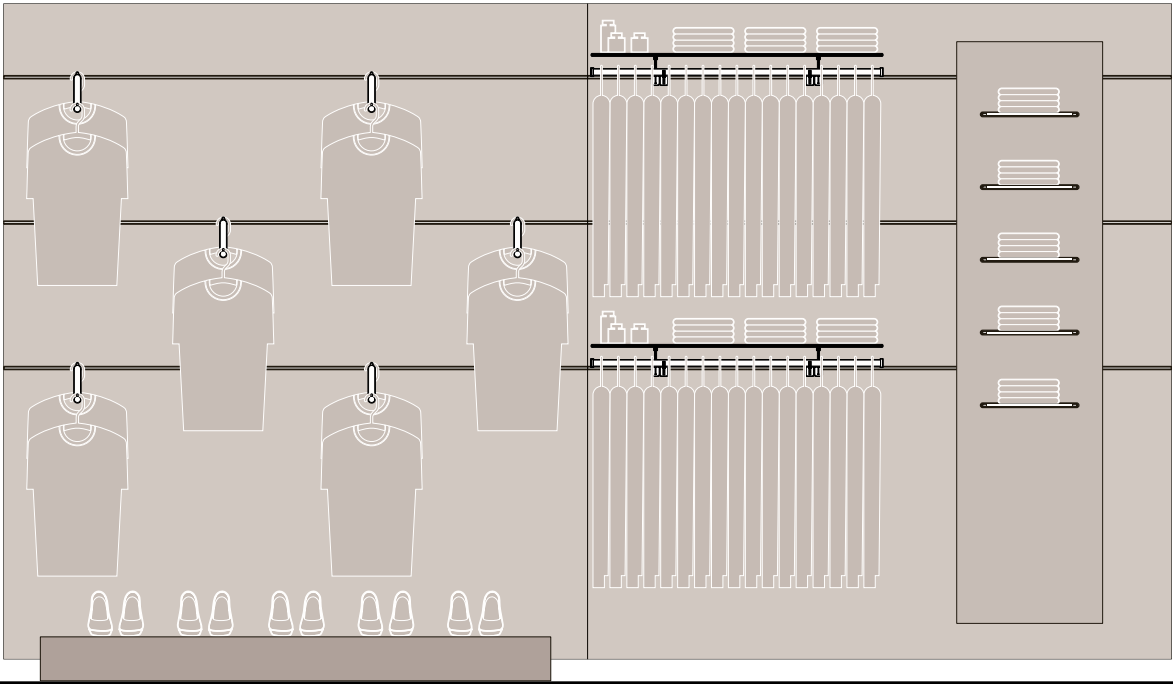

B

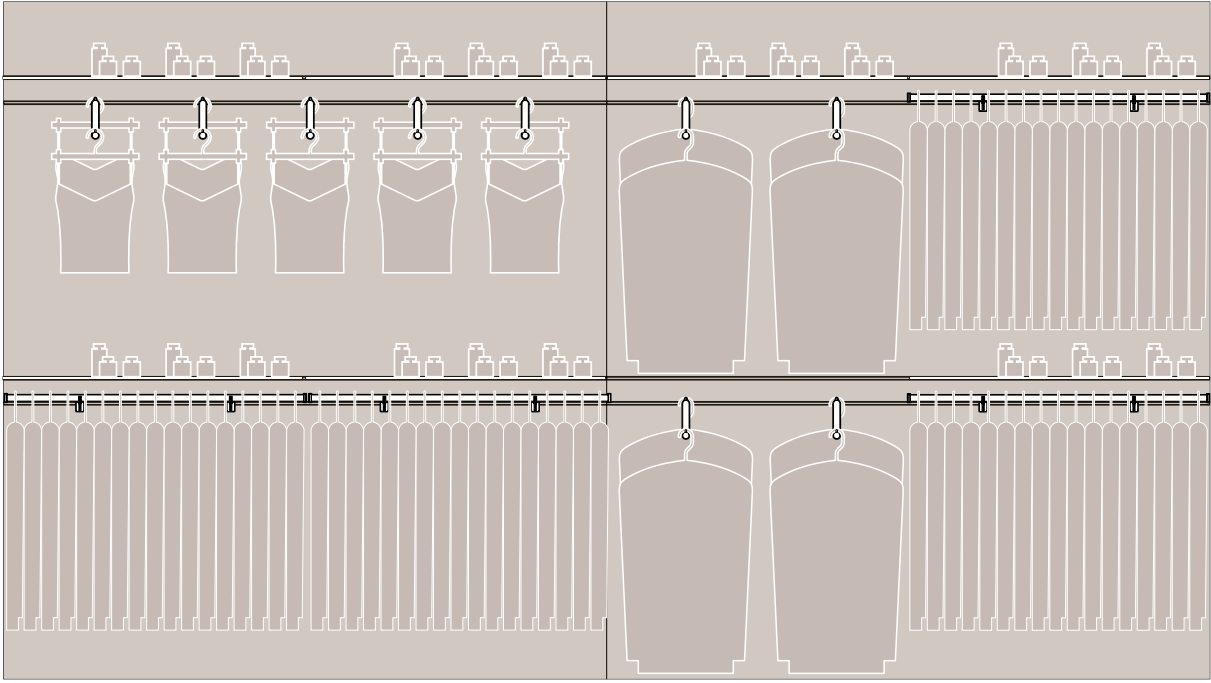

D

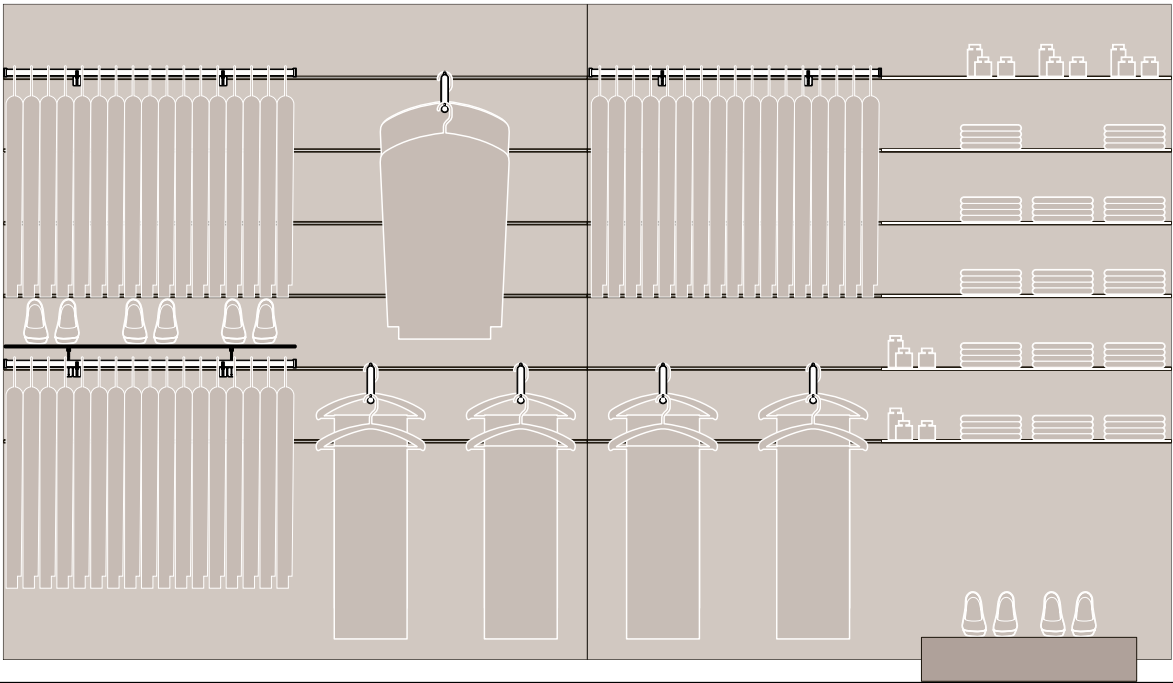

E

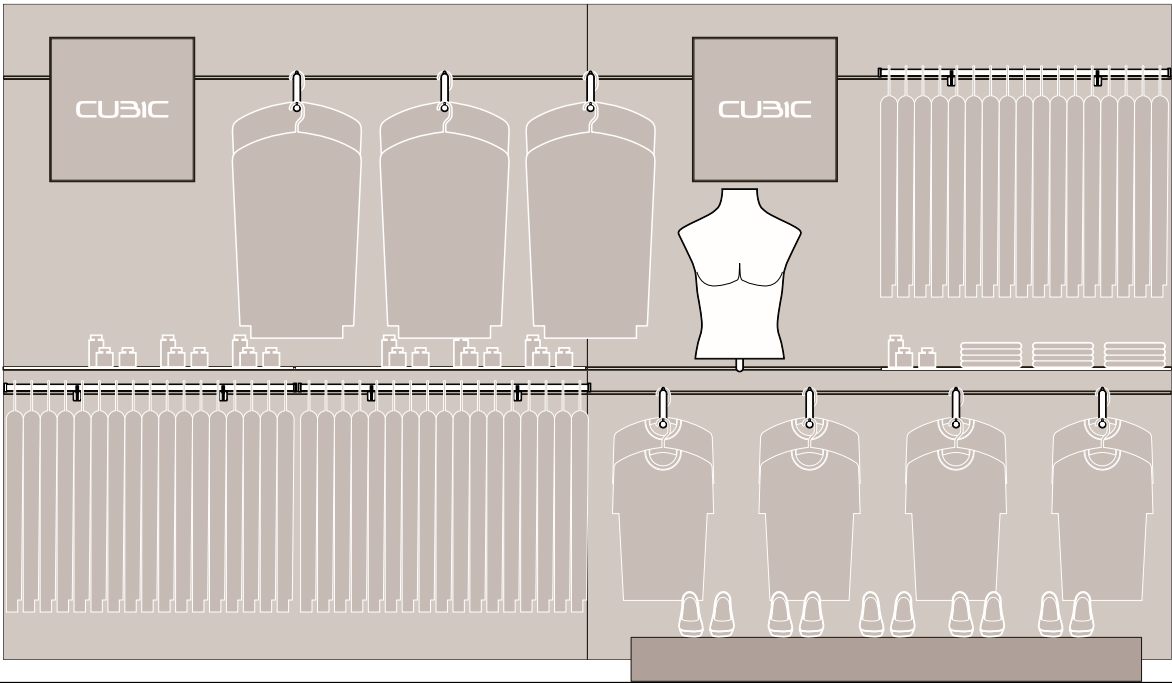

G

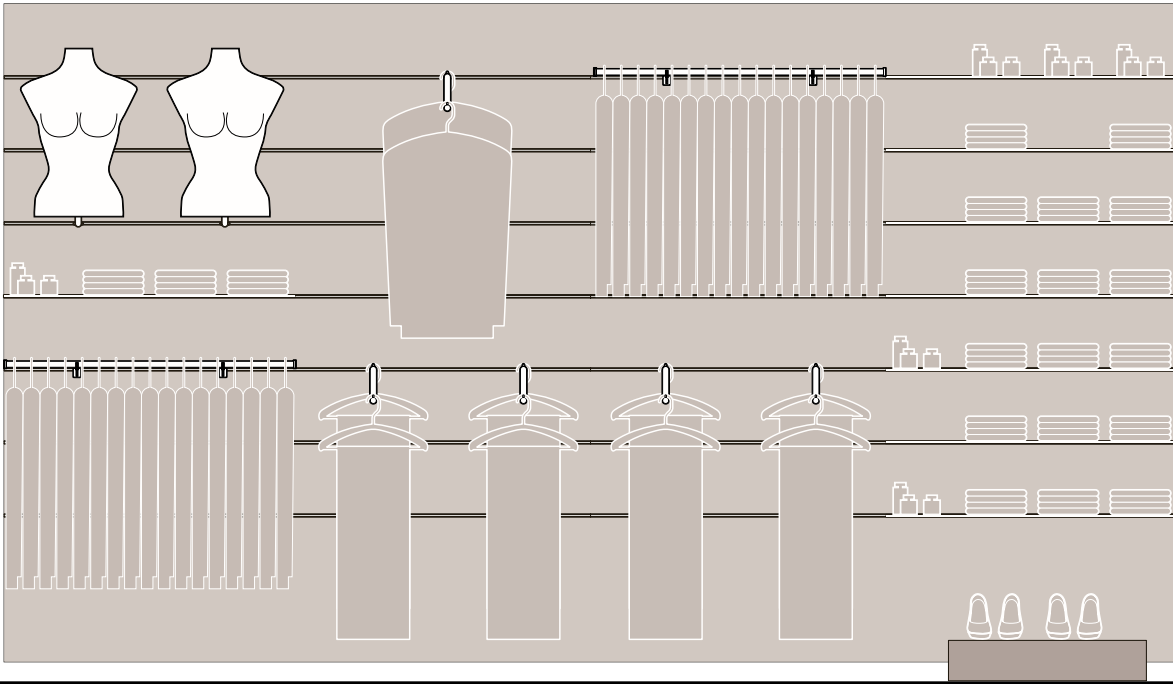



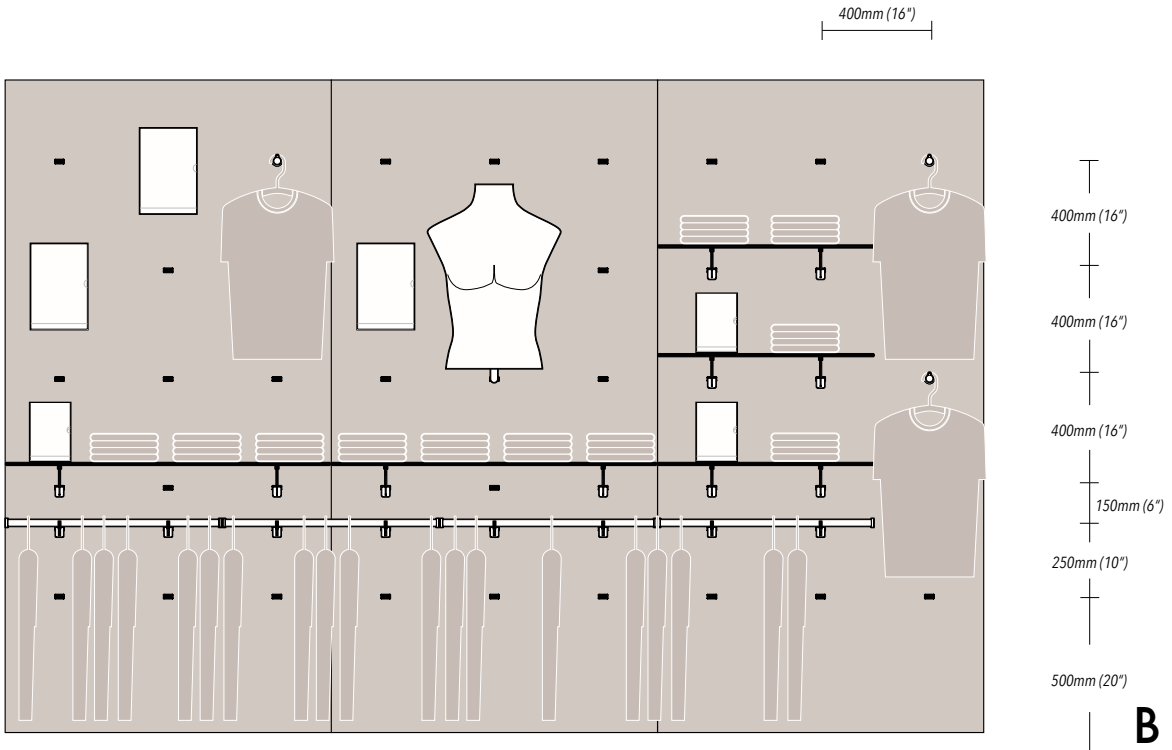
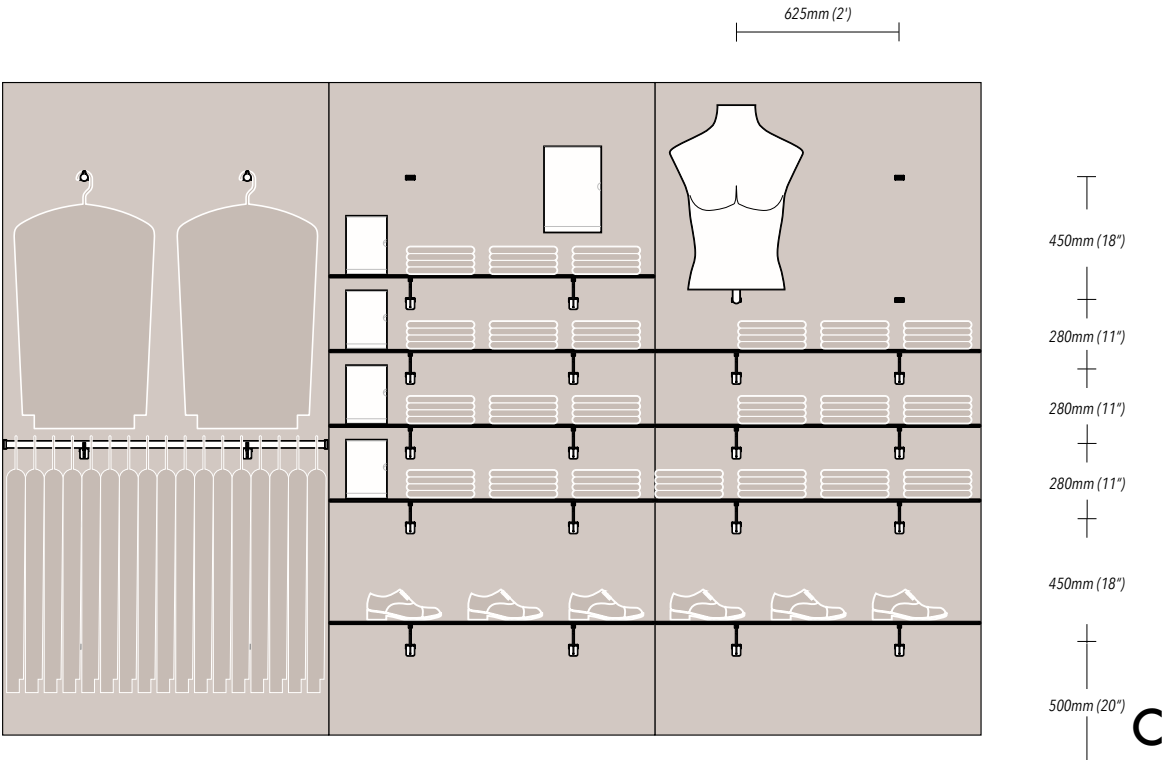
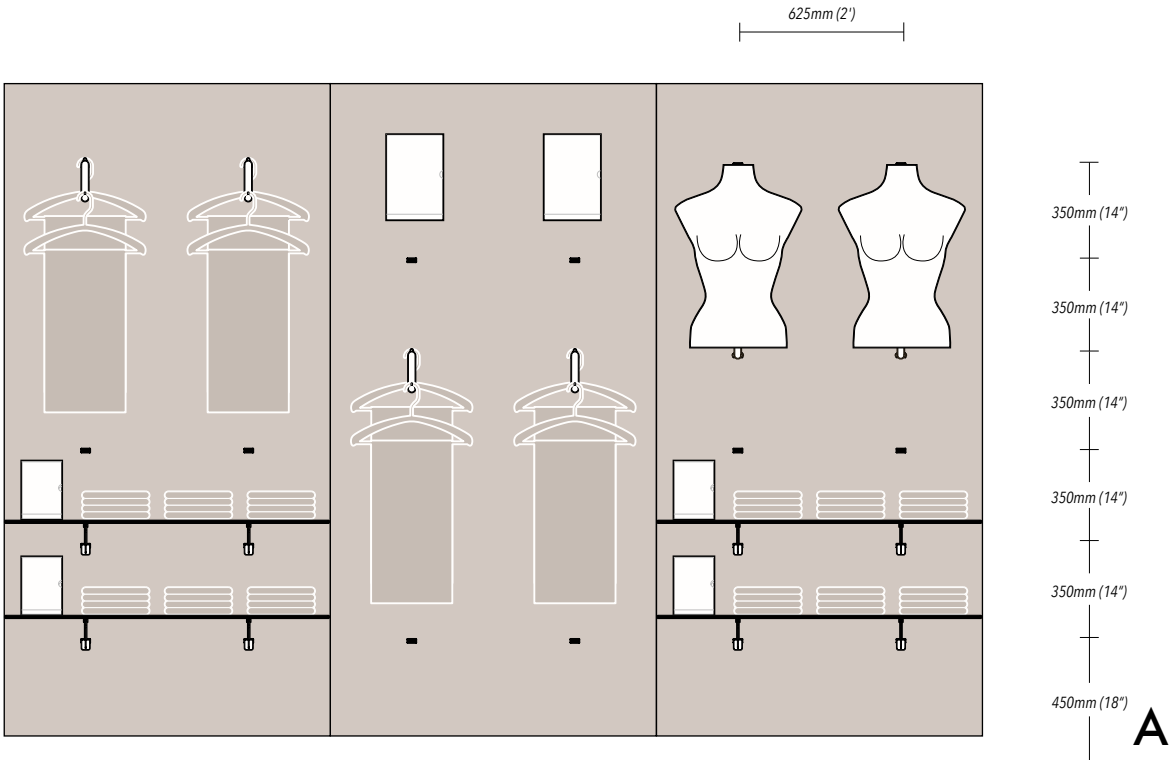



F



Technical Information

Your CUBIC Architectural Representatives can provide technical documentation, production drawings and other useful resources. You may also simply download a variety of support tools from the CUBIC Library - [cubic.co/library](#). A member login key is required to access this section. To acquire a login key or any other technical enquiries contact your CUBIC Architectural Representatives or email CUBIC corporate at info@cubic-mail.cn.

Symbols

 Information	 Package content	 Dimensions
 Assembly example	 Downloadable production drawing	 Maximum load

Specifications

- All dimensions provided within are in millimetres (approximate dimensions are provided in inches for reference only).
- All weights are in kilograms (approximate weights are provided in pounds for reference only).
- All threads, screws, bolts & nuts specified within & provided are metric.
- All glass used is tempered (safety) glass.

'Made to Order'

Our products are inventoried in our standard finishes and surface treatments, however that is just the beginning of what is possible.

Custom solutions are at the heart of what we do for our customers and our “Made to Order” program provides our clients maximum flexibility in realising their creations with a variety of finish possibilities.



'Made to Order' quantity guide

Next to many of the items we have presented, there are several “Made to Order” finish suggestions as well as the quantity guideline to assist you in the planning and production of the custom finish. This program is not for every project... it does require some planning and a little extra time to get it right. Our Architectural Representatives are eager to help you navigate the process.

Safety Information

CUBIC are dedicated to ensuring that our products offer the highest level of safety.

All products have been vigorously tested for safety and durability. It must be noted that the safety of our products are subject to:

- *Observing national regulations*
- *Observing accident prevention regulations*
- *Installation according to CUBIC instructions*
- *Installation only on structurally sound and appropriate walls, ceilings and floors*
- *Panels being strengthened with wooden beams or angle sections to prevent bowing*
- *A safety check being performed before drilling into any surface*
- *Use of products only upon completion of installation*
- *Appropriate use of the products*
- *Using only original or approved accessories*
- *Keeping within recommended weight loading specifications as per CUBIC literature*
- *Using only tempered (safety) glass*
- *Avoiding alterations and adaptation where not appropriate and not approved by CUBIC*
- *Maintaining a common level of caution and alertness when in use*
- *Keeping away anyone whom is not qualified to use CUBIC products, in particular children*

Important: *Only qualified people must be used for design, installation and disassembly of CUBIC products. It is highly recommended that all persons involved in design, installation, disassembly and use of these products read the CUBIC assembly instructions and specifications literature to become fully aware of the safety measures that must be followed.*

Sales Terms

General CUBIC™ delivery conditions, payment terms, warranty and return policy are valid for all orders. Please contact your CUBIC™ representative for further information.

Intellectual Property

All information, images, products and names shown in this document, whether registered or not, are intellectual property rights. We reserve the right to take legal steps against any infringement of our intellectual property. Various CUBIC™ products are the subject of patent applications filed in accordance with the Paris Convention for the Protection of Industrial Property.

Other single point display systems you may want to consider: **Flex H, Flex D, Flex S & Flex Q.**

Other horizontal slot display systems you may want to consider: **Trax H (H3, H6 & H8).**

082015
metric (imperial)

cubic.co

info@cubic.co

The material contained in this document may contain inaccuracies or typographical errors and may be subject to modification or update by CUBIC™ without prior notice.